



## Refrigeration for vehicles

Fridges | Freezers | Portables | Ice Makers | Drawer Fridges



# Welcome to the Penguin Refrigeration product guide.

Penguin Refrigeration is the UK's leading distributor and stockist of 12v & 24v fridges and freezers. Exclusively manufactured in Italy, our refrigeration is built to the highest specification ensuring years of efficient, trouble free operation.

This guide is designed to help you select the best refrigeration for your campervan or motorhome, including options and choices available such as remote mounted compressors, fitting frames, catches and more. We can also provide information on installation and ventilation if required. Basic wiring guides are included in this brochure, but for the more adventurous, we can advise on running our 12v/24v refrigeration from solar or wind power.

If you need any further clarification please call us on 0845 257 7798 or visit our website: [www.penguinfrigo.co.uk](http://www.penguinfrigo.co.uk)

## VITRIFRIGO OPTIONS AND ACCESSORIES

- |                                    |   |
|------------------------------------|---|
| <b>1</b> Magnetic door seal        | <b>8</b> Left or right hinge                            |
| <b>2</b> Optional salad bin        | <b>9</b> Pinstop catch or optional Nautic Latch         |
| <b>3</b> Height adjustable shelves | <b>10</b> Removable fascia panel                        |
| <b>4</b> Ice box                   | <b>11</b> Optional fitting frame (see page 3)           |
| <b>5</b> Interior light            | <b>12</b> Compressor space - can also be remote mounted |
| <b>6</b> Bottle holders            |   |
| <b>7</b> Clip on bottle dividers   |   |

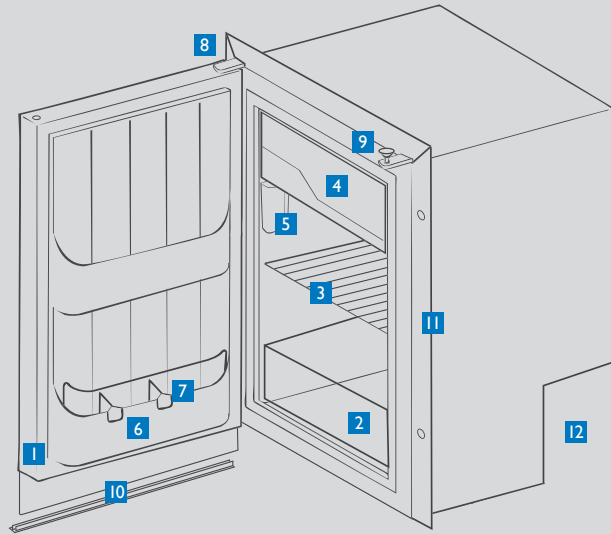

## OCEAN WHITE FRIDGES



Widely used in large recreational vehicles, if volumes and price are the key criteria, the Ocean White Range is hard to beat. However, they are not built to the marine specification of our other fridges and are less efficient as a result. 12/24v cooling units upgradeable to 12/24v 110-240v.



C190DP

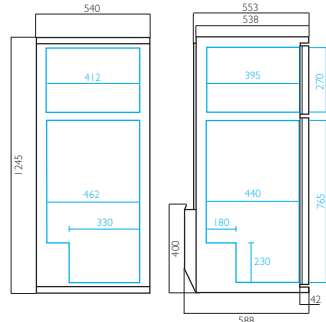

	FRIDGE/FREEZER VOLUME (L)	HEIGHT (MM)	WIDTH (MM)	DEPTH (MM)	FLUSH DEPTH (MM)	COMPRESSOR	WEIGHT (KG)
<b>C160MP</b>	150/14	1070	540	560	600	Integral	38.0
<b>C190DP</b>	133/40	1215	540	560	600	Integral	42.0
<b>C220MP</b>	221/14	1415	540	560	600	Integral	44.0
<b>C220DP</b>	176/40	1415	540	560	600	Integral	46.0
<b>C240DP</b>	176/40	1620	540	560	600	Integral	55.0
<b>C270DP</b>	190/64	1827	540	560	600	Integral	59.0

## TOP LOADERS & PORTABLES



Top-loading refrigerators are a good option when trying to squeeze additional refrigeration into a galley. C37BT and C65 are available as freezers. Vitrifrigo also produces portable fridges in three volumes. Well insulated, these rugged boxes are able to run at -10°C & below. Upgradeable to 12/24v 110-240v.

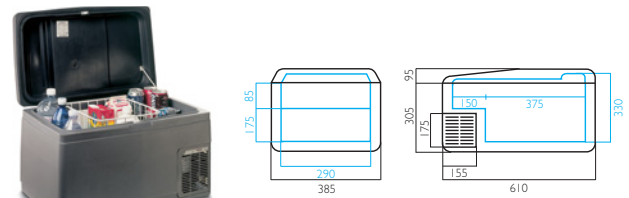
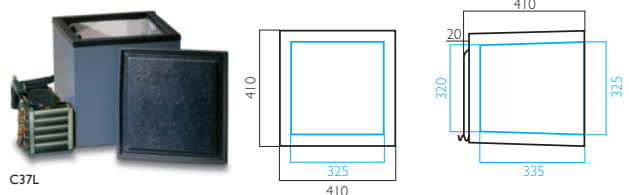

	VOLUME (LITRES)	HEIGHT (MM)	WIDTH (MM)	DEPTH (MM)	COMPRESSOR	WEIGHT (KG)
<b>C37L</b>	37	410	410	410	Remote	15.5
<b>C37BT</b>	37	410	410	410	Remote	15.5
<b>C40L</b>	40	400	420	420	Remote	12.0
<b>C26</b>	26	385	345	510	Integral	16.0
<b>C41</b>	41	400	385	610	Integral	22.2
<b>C65</b>	65	450	510	725	Integral	23.5





## OCEAN FRIDGES



Built exclusively in Italy, the Vitrifrigo philosophy is to build quality refrigeration engineered to last. We stock their entire range of 12/24v fridges in the UK. They all feature power efficient aluminium finned cooling units, and compressors can be integral to the cabinet or remote and are easily upgraded to run 12/24v and 110/240v.



C42L

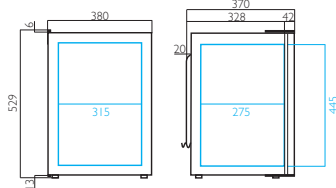

C62I

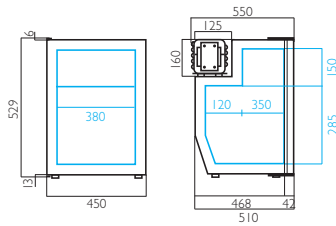

DP2600I

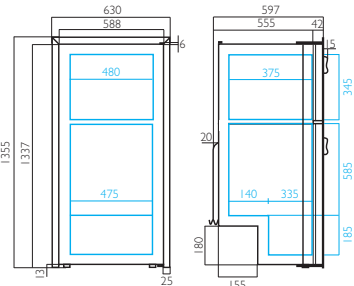

	FRIDGE/FREEZER VOLUME (L)	HEIGHT (MM)	WIDTH (MM)	DEPTH (MM)	FLUSH DEPTH (MM)	COMPRESSOR	WEIGHT (KG)
<b>BRK35</b>	35	250	452	660	710	Integral	15.7
<b>BRK35SS</b>	35	250	506	-	708	Integral	15.7
<b>C39I</b>	38	544	390	345	387	Integral	15.7
<b>C42L</b>	40	529	380	328	370	Remote	15.8
<b>C45L</b>	40	544	390	345	387	Remote	16.1
<b>C47</b>	47	393	430	630	672	Integral	20.0
<b>C50I</b>	50	634	395	345	387	Integral	15.7
<b>C51I</b>	51	529	380	480	522	Integral	17.2
<b>C60I</b>	60	619	470	405	447	Integral	15.8
<b>C62I</b>	62	529	450	550	592	Integral	19.6
<b>C75L</b>	75	619	470	405	447	Remote	21.2
<b>C85I</b>	90	789	485	415	457	Integral	26.5
<b>C90I</b>	87	619	470	500	542	Integral	25.5
<b>C95L</b>	95	783	485	414	456	Remote	26.0
<b>C115I</b>	118	764	525	510	552	Integral	21.2
<b>C130L</b>	133	764	525	510	552	Remote	27.4
<b>DP150I</b>	118/30	1094	525	510	552	Integral	38.8
<b>DP2600I</b>	170/60	1355	630	-	597	Integral	64.5

## COOLING UNITS

All fridges are supplied with 12v/24v compressors with aluminium finned condensers for maximum efficiency. Easily upgraded to run 12/24v 110/240v or can be supplied with quick couplings if required.



## OCEAN FREEZERS



Well insulated 12/24v freezers supplied with remote mount compressors to maximise capacity. Features include stainless steel internal liner with hidden evaporator, and efficient air cooled aluminium finned cooling units as standard. These are easily upgraded to water cooled or to run 12/24v and 110/240v.



C30BT

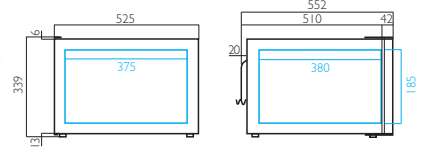

C110BT

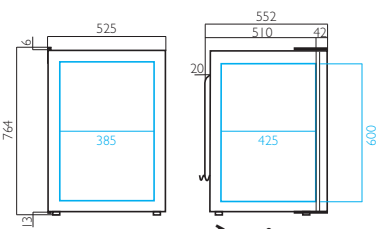

	VOLUME (LITRES)	HEIGHT (MM)	WIDTH (MM)	DEPTH (MM)	FLUSH DEPTH (MM)	COMPRESSOR	WEIGHT (KG)
<b>C30BT</b>	30	339	525	510	552	Remote	21.8
<b>C35BT</b>	33	544	390	345	387	Remote	22.9
<b>C55BT</b>	56	619	470	405	447	Remote	29.8
<b>C110BT</b>	108	764	525	510	552	Remote	41.2

## FITTING FRAMES

Standard or flush mount fitting frames are ideal for making up small differences in width and height when retrofitting units.



Standard fitting frame



Flush fitting frame

## ICE MAKERS



The icemaker of choice for the UK's leading power and sailboat manufacturers. Compact and producing 7kg of ice per 24 hours they are available as mains or bottle fed. For higher capacity requirements we also supply the Frigoboat CB range which produce up to 28kg of clear ice in 24 hours.



IM REFILL

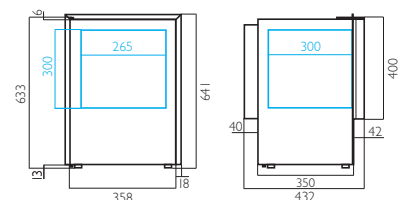

	VOLTAGE	HEIGHT (MM)	WIDTH (MM)	DEPTH (MM)	FLUSH DEPTH (MM)	WATER FEED	WEIGHT (KG)
<b>IM HYDRO</b>	220/110	641	432	358	400	Mains	25.0
<b>IM REFILL</b>	220/110	641	432	358	400	Bottle	25.0
<b>IM XT</b>	220/110	470	523	354	396	Mains	26.0
<b>CB184</b>	220	590	355	404	446	Mains	28.0
<b>CB246</b>	220	610	390	460	502	Mains	35.0
<b>CB249</b>	220	690	390	460	502	Mains	37.0

## OCEAN STAINLESS DRAWERS



Elegant and functional, the Vitrifrigo Drawers start with single fridge or freezer drawers (70 or 100 litres), moving up to larger capacity twin drawer under-counter units (180 or 210 litres). Twin drawers can be produced as all fridge, all freezer, or a combination of both. An icemaker is optional on all freezer drawers. All models are available with either standard or flush mount fitting frames. All drawers are easily upgraded to water cooled or to run 12/24v and 110/240v.



DW70

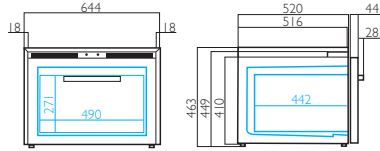

DW180

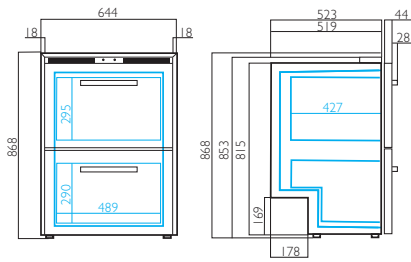

DW360

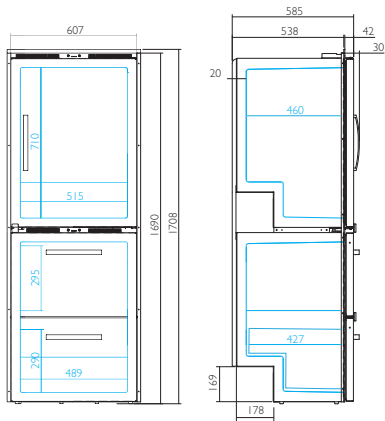

Freezer drawer with ice maker



Fridge drawer with basket

	VOLUME (LITRES)	HEIGHT (MM)	WIDTH (MM)	DEPTH (MM)	FLUSH DEPTH (MM)	COMPRESSOR	WEIGHT (KG)
<b>DW70*</b>	75	448	644	520	562	Remote	26.0
<b>DW100*</b>	95	543	562	591	633	Remote	27.0
<b>DW180.2**</b>	64/80	853	644	523	565	Integral	59.0
<b>DW210.2**</b>	192	865	717	552	594	Integral	60.0
<b>DW250**</b>	157/75	1314	607	540	582	Integral	60.0
<b>DW360**</b>	157/144	1690	607	540	582	Integral	100.0

\* Single drawers are available as fridge, freezer or freezer with icemaker (110v-240v only).

\*\* Double drawers are available as 2x fridge, 1x fridge & 1x freezer, 2x freezer and an ice maker can be fitted to the top drawer on freezer and fridge freezer models (110v-240v only).

## OCEAN STAINLESS FRIDGES



These Vitrifrigo fridges look superb with their flush mount, rolled edge doors in brushed stainless steel. With the functional Nautic latch they make an excellent addition to any galley and are also ideal for wet bars and cockpit fridge applications. Upgradable to run 12/24v and 110/240v.



C130LX

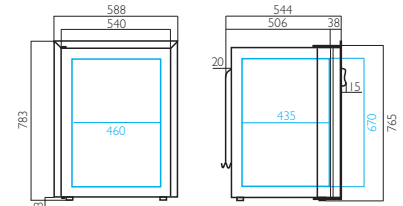

DP2600IX

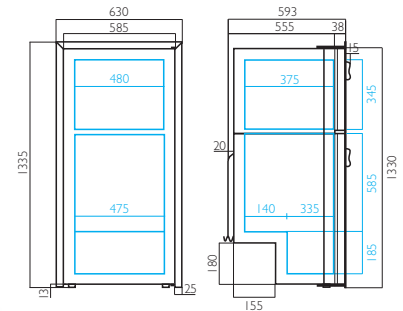

Nautic latch



Flush fitting frame

	VOLUME (LITRES)	HEIGHT (MM)	WIDTH (MM)	FLUSH DEPTH (MM)	COMPRESSOR	WEIGHT (KG)
<b>C42LX</b>	40	563	443	362	Remote	15.8
<b>C511X</b>	51	563	443	518	Integral	17.2
<b>C601X</b>	60	638	533	439	Integral	15.8
<b>C621X</b>	62	548	513	546	Integral	19.6
<b>C75LX</b>	75	638	533	439	Remote	21.2
<b>C851X</b>	90	808	548	449	Integral	26.5
<b>C1151X</b>	118	783	588	544	Integral	21.2
<b>C130LX</b>	133	783	588	544	Remote	27.4
<b>C180LX</b>	180	853	608	560	Integral	48.0
<b>DP2600IX</b>	230	1335	630	555	Integral	64.5

## TYPICAL POWER CONSUMPTION

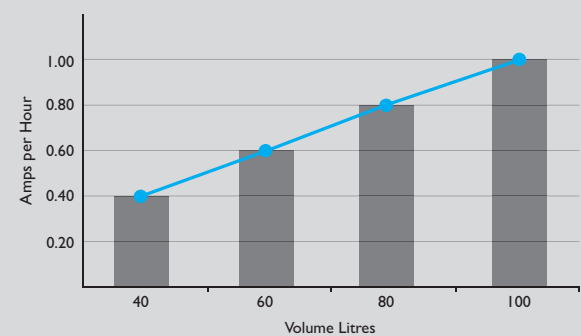

\* Figures based on readings taken during UK summer with no restocking of fridge. For full details on power consumption please visit our website [www.penguinfrigo.co.uk](http://www.penguinfrigo.co.uk)

# INSTALLATION GUIDE AND TIPS

Correctly installed and ventilated, a 12/24v (DC) fridge will provide years of faithful service. In our experience it is extremely rare for a DC compressor to fail and the most common fridge fault is electrical. This is because DC fridges are very sensitive to voltage due to the relatively high start loads. If the wiring is undersized or there is any corrosion, or a poor connection in the wiring, the compressor will not start.

Below are the common wiring diagrams for the Danfoss compressors plus some basic trouble-shooting tips. However, remember as we said at the beginning of the catalogue, if in doubt please ask. Call or email us anytime - whatever make of your marine fridge, we are happy to help and advise you.

## BASIC CONTROLLER

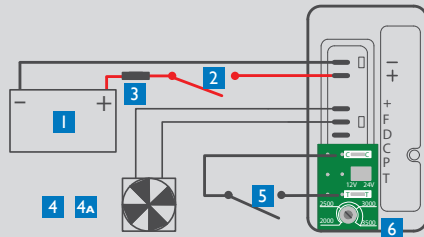

- 1 Battery
- 2 Isolation switch
- 3 Fuse (12v 15 amp - 24v 8 amp)
- 4 Fan
- 4A Water pump via relay
- 5 Thermostat
- 6 Optional speed board

## MULTI VOLTAGE CONTROLLER

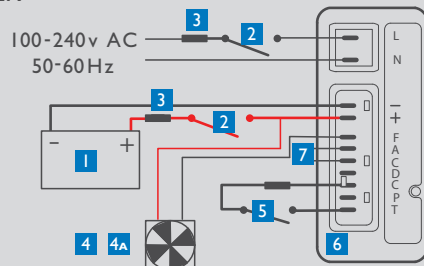

- 1 Battery
- 2 Isolation switch
- 3 Fuses correctly rated
- 4 Fan DC
- 4A Water pump via relay
- 5 Thermostat
- 6 Optional speed board
- 7 DC light

## BASIC FAULT FINDING - WHAT TO LOOK FOR IF YOUR FRIDGE OR FREEZER DOES NOT COOL

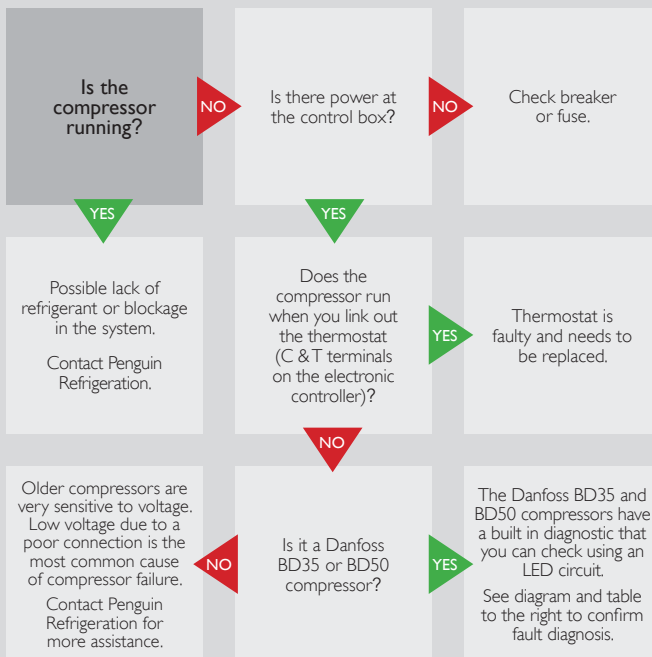

### DANFOSS BD35 & BD50 DIAGNOSTIC

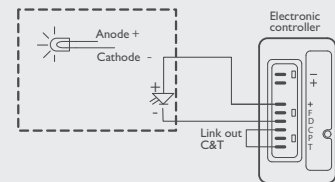

Flashes per 4 sec.	Fault / corrective action
ONE	<b>Low voltage:</b> The fault is likely to be your supply. Check your cables and connections. If in doubt run new correctly sized wires direct from battery.
TWO	<b>Faulty fan:</b> Unplug the fan, if the compressor runs replace the fan.
THREE*	<b>Compressor non-start error:</b> This may be the controller that has failed, but can also be caused by low voltage. Check your wiring and connections. Turn system off and re-start after 5 minutes. If still flashing 3, contact Penguin Refrigeration.
FOUR	<b>Compressor overload:</b> Contact Penguin Refrigeration.
FIVE	<b>Electronic temperature overload:</b> Contact Penguin Refrigeration.

\*This is a common occurrence if power is interrupted and restored too quickly.

The full version of this fault finding diagram plus other useful trouble-shooting manuals and self-help fault diagnostics are available on our technical help site - [www.fixmyfridge.co.uk](http://www.fixmyfridge.co.uk)



Unit 8, Downley Point, Downley Road, Havant, Hampshire, PO9 2NA  
TEL 0845 257 7798 EMAIL [sales@penguinfrigo.co.uk](mailto:sales@penguinfrigo.co.uk)

[www.penguinfrigo.co.uk](http://www.penguinfrigo.co.uk)

OFFICIAL UK DISTRIBUTORS FOR

