

CALL TO ORDER ON 01202 671661  
EMAIL KRIS@HOBIECATCENTRE.CO.UK

2013



 **HOBIE**  
STAND UP PADDLEBOARDS

# RACE

## 12.6/14.0 E-SERIES

Hobie's E-Series boards have been developed by Hobie's world class water athletes and R & D team. Utilizing computer aided shaping technology and countless hours of on the water testing and racing, we have been able to zero in on critical performance factors in the perfection of our designs. E-Series boards were developed to be fast in all conditions, have a stable confident feeling on the water, and maintain momentum in between strokes and paddle changes.



£1700 inc.VAT  
E-SERIES  
14'



£1475 inc.VAT  
E-SERIES  
12'6"

Length	14' (427cm)	12'6" (381cm)
Width	29" (73.66cm)	28.875" (73.88cm)
Thick	6.6" (16.76cm)	6.6" (16.76cm)
Volume	285.7L	249L
Weight *approximate	28lb (12.7kg)	24.5lb (11.1kg)

### Bamboo Composite Epoxy + Carbon Technology

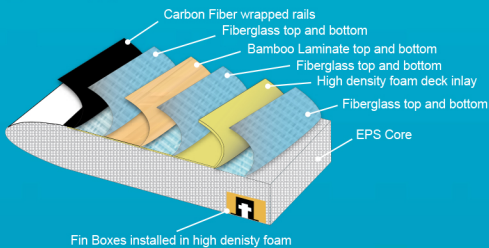

### Series Features

- Built in hand hold
- 2Way Vent
- Leash Plug
- EVA Pad
- Race Fin



## Colin McPhillips Torque Series

The "Colin McPhillips Torque" Series is a complete line of progressive surfing stand up paddleboards inspired by 3x Longboard World Champion and World Class SUP surfer Colin McPhillips. The Torques are very stable, fast to paddle and catch waves with ease and absolutely rip in a variety of surf SUP conditions.



£1090 inc. VAT



CM TORQUE  
9'4"

£1035 inc. VAT



CM TORQUE  
8'11"

£999 inc. VAT



CM TORQUE  
8'4"

9'4"  
(284.4cm)

28.75"  
(72.4cm)

4.5"  
(11.4cm)

131.1L

19lb  
(8.6kg)

8'11"  
(271.8cm)

28.875"  
(72.4cm)

4.3"  
(10.92cm)

120.5L

17lb  
(7.7kg)

8'4"  
(254cm)

28.5"  
(72.4cm)

4.3"  
(10.92cm)

110.5L

16lb  
(7.3kg)

### HOBIE INTEGRATED HANDLE

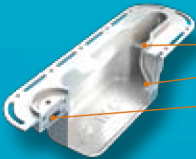

- 3 in 1 Design
- Integrated Security Bar for locks
- Ergonomic Hand Hold
- 2Wayv Vent

### Series Features

- Built in hand hold
- 2Wayv Vent
- EVA traction pad
- Future Side Fins
- Center fin
- Leash Plug



### 2 Way V - Venting System

A unique hassle free two-way vent system that equalizes pressure due to temperature or altitude variation.



# RACE MADE IN THE USA

## SUP RAW SERIES

HOBBIE SUP RAW represents a high quality, high performance SUP board priced competitively and MADE IN THE USA! No Gimmicks, no smoke and mirrors just the RAW Essentials! The combination of Hobie's cutting edge design and CLK construction results in the most responsive high performance board on the market today!



**CALL US ON 01202 671661 FOR FURTHER DETAILS AND PRICES**



**RAW RACE**  
14'



**RAW RACE**  
12'6"



**RAW RACE**  
FLATWATER 12'6"

Length	14" (427cm)	12'6" (381cm)	12'6" (381cm)
Width	29" (73.66cm)	28.875" (73.88cm)	27.58" (70.05cm)
Thick	6.6" (16.76cm)	6.6" (16.76cm)	5.4" (13.72cm)
Volume	285.7L	249L	204.7L
Weight *approximate	24.5lb (11.1kg)	22lb (10kg)	22lb (10kg)



### Cross Link Hybrid Composite Lamination

Hobie introduces CLK Lamination to its line of RAW RACE and SUP RAW models. The CLK Lamination technique as it applies to SUPs has been perfected by the master laminators at our Hobie Glass Shop, and utilizes space age cross link hybrid laminating technology to produce a light weight, high quality, and high performance stand up paddleboards.

### Series Features

- Built in hand hold
- 2Way Vent
- Leash Plug
- EVA Pad
- Race Fin



## CM RAW SERIES

Inspired by 3x Longboard World Champion and World Class SUP surfer Colin McPhillips; CM RAW boards are very stable, fast to paddle and catch waves with ease and absolutely rip in a variety of surf SUP conditions!

**CALL US ON 01202 671661 FOR FURTHER DETAILS AND PRICES**



### CM RAW LB SERIES



CM RAW LB 10'6"      CM RAW LB 9'8"      CM RAW LB 9'

### CM RAW SERIES



CM RAW 9'4"      CM RAW 8'11"      CM RAW 8'4"      CM RAW 7'11"

10'6"	9'8"	9'	9'4"	8'11"	8'4"	7'11"
(320cm)	(294.6cm)	(274.3cm)	(284.4cm)	(271.8cm)	(254cm)	(241.3cm)
30"	29.5"	30"	28.75"	28.75"	28.5"	28.5"
(76.2cm)	(74.9cm)	(76.2cm)	(73.03cm)	(73.03cm)	(72.4cm)	(72.4cm)
4.75"	4.75"	4.5"	4.5"	4.3"	4.3"	4.25"
(12.06cm)	(12.06cm)	(11.43cm)	(11.43cm)	(10.92cm)	(10.92cm)	(10.79cm)
168.6L	151.2L	137.2L	131.1L	120.5L	110.5L	101.1L
19lb	18lb	15lb	16lb	14lb	12.5lb	12lb
(8.6kg)	(8.2kg)	(6.8kg)	(7.3kg)	(6.4kg)	(5.7kg)	(5.4kg)

### HOBIE INTEGRATED HANDLE

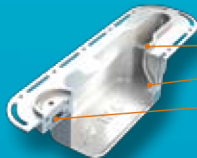

- 3 in 1 Design
- Integrated Security Bar for locks
- Ergonomic Hand Hold
- 2WayV Vent

### Series Features

- Unidirectional Carbon Cloth Stringers Top & Bottom
- Hand Hold
- 2WayV Vent
- Future Side Fins
- Leash Plug
- Padded or Non - Padded Option
- Center fin



### 2 Way V - Venting System

A unique hassle free two-way vent system that equalizes pressure due to temperature or altitude variation.

# RECREATION

## INFLATABLE SERIES

Incorporating all the same technical design aspects from the rest of the Hobie SUP line, The Hobie Inflatable Series makes stand up paddling easy, fun, and portable. Perfect for families or travelers on the go, the entire Hobie Inflatable Series stores neatly and compact, and can be ready to go in a matter of minutes.



£1010 inc.VAT  
**TOUR**  
12'6



£920 inc.VAT  
**TOUR**  
10'6



£920 inc.VAT  
**ADVENTURE**  
10'8



£790 inc.VAT  
**ATR**  
10'8

Length	12'6" (381cm)	10'6" (320cm)	10'8" (330cm)	10'8" (330cm)
Width	32" (81.3cm)	32" (81.3cm)	32" (81.3cm)	32" (81.3cm)
Thick	5.75" (14.6cm)	5.75" (14.6cm)	5.75" (14.6cm)	<b>4.25"</b> (14.6cm)
Volume	298.2L	245.9L	272.5L	272.5L
Weight *approximate	28lb (12.7kg)	27lb (12.2kg)	27lb (12.2kg)	27lb (12.2kg)

## Series Accessories



Heavy duty  
backpack  
storage bag



EXP - 3 Piece Paddle  
*optional*



Pump w/ gauge



Repair Kit



Dry Bag  
*optional*



Electric Pump  
*optional*



£870 INC VAT  
**SCHOOL**  
 10'2"

£780 INC VAT  
**DRIFTER**  
 10'

10'2"  
 (310cm)

33"  
 (83.82)

4.25"  
 (14.6cm)

196L

28lb  
 (12.7kg)

10'  
 (305cm)

32"  
 (81.3cm)

4.25"  
 (14.6cm)

193.3L

23lb  
 (10.4kg)

### Series Features

- Hi-Tech drop-stitch construction allowing inflation over 10 PSI for extreme rigidity
- High pressure spring valve for quick and easy inflation and deflation
- Large EVA foot pad provides grip and comfort
- Built in convenient carry handle and 4 built in utility handles
- Removable center fin & tri fin on some models
- Stainless steel D-rings for tying off to boats, docks, etc
- Bungee tie down system (*not on all models*)



Durable Polyethylene skin

Polyurethane foam core



Integrated Fin Boxes



# RECREATION



## ATRii SERIES

Incorporating over 6 years of SUP building knowledge, the next evolution of the highly popular ATR Series, the ATRii incorporates all the great characteristics of the first series with a much more active approach.

£1130 INC. VAT



ATR II  
11'

£1095 INC. VAT



ATR II  
10'

Length	11' (81.28cm)	10' (12.32cm)
Width	31.5" (80cm)	32" (81.28cm)
Thick	4.98" (12.65cm)	4.75" (12.07cm)
Volume	206.8L	181.1L
Weight *approximate	26lb (11.8kg)	25lb (11.3kg)

## Bamboo Composite Epoxy Technology

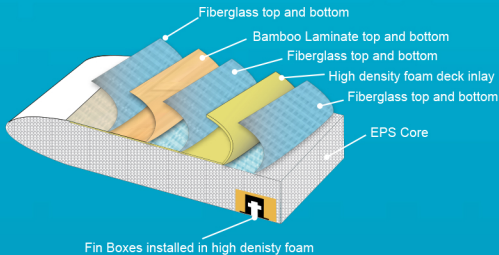

## Features

- BCX - Bamboo Epoxy Construction
- Hand Hold
- 2Wayv Vent
- Leash Plug
- 3/4 length EVA pad

**VENTURE SERIES**

A true multi use board, this versatile design fuses distance, touring, and surf features. The result is a go any wear do anything board perfect for both ocean and lake excursions.

£1175 INC. VAT

**VENTURE**  
 10'4"

 10'4"  
 (315cm)

 30"  
 (76.2cm)

 4.85"  
 (16.76cm)

192.5L

 24lb  
 (10.9kg)

**CM LB SERIES**

Featuring contours similar to the Torque Series, the CM LB Series features a high performance bottom and rails with a more fuller outline, perfect for the larger advanced surf paddler or someone looking for a smaller recreational board.

£1115 INC. VAT

**CM LB**  
 10'6"

 10'6"  
 (320cm)

 30"  
 (76.2cm)

 4.75"  
 (12.07)

168.6L

 22lb  
 (10kg)

£1085 INC. VAT

**CM LB**  
 9'8"

 9'8"  
 (294.6)

 30"  
 (76.2cm)

 4.75"  
 (12.07cm)

151.2L

 20lb  
 (9kg)

£1040 INC. VAT

**CM LB**  
 9'

 9'  
 (274.3cm)

 30"  
 (76.2cm)

 4.5"  
 (11.43cm)

137.2L

 18lb  
 (8.2kg)

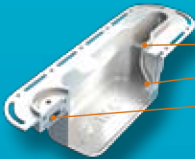
**HOBIE INTEGRATED HANDLE**

- 3 in 1 Design
- Integrated Security Bar for locks
- Ergonomic Hand Hold
- 2Way Vent

**2 Way V - Venting System**

A unique hassle free two-way vent system that equalizes pressure due to temperature or altitude variation.

# PADDLES

## PRO CARBON SERIES

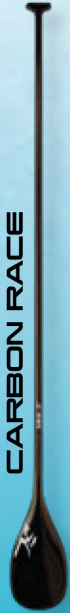

£245 INC. VAT



£245 INC. VAT

## RECREATION SERIES



£130 INC. VAT



£175 INC. VAT



£175 INC. VAT

Length	86" Max (218cm)	86" Max (218cm)	86"Max (218cm)	70"-82" (178-208cm)	65"-80" (165-203cm) <i>"collapses to 30"</i>
Material	Carbon	Carbon Fiberglass	Fiberglass	Fiberglass	Fiberglass
Blade Width	8.5" (21.6cm)	7.8" (19.8cm)	7.5" (19cm)	7.5" (19cm)	7.5" (19cm)
Weight	16.9 oz /@ 78" 479 g	19.75 oz /@ 78" 558 g	28.75 oz /@ 78" 815 g	32.55 oz 923 g	33.02 oz 939 g

## PADDLE FEATURES

### • Handle

An ergonomically designed handle for maximum comfort and control.



### • Shaft

Lightweight tapered oval shaft designed to be light, quick, stiff and comfortable with a bit of snap.

### • Blades

- 7.8in / 19.8cm blade width
- 8.5in / 21.6cm blade width
- Dihedral blades incorporate a center spine and a 11 degree blade angle translating into the perfect combination of stiffness, strength, control and power.







SUP Leash

AVAILABLE IN 9 FOOT  
OR 10 FOOT  
£35.00 INC.VAT



**Board Bags**

14' - 12'6" - 12' - 11'2"  
10'4" - 9'6" - 8'6"

BOARD BAG 8'6" TO 12' £115  
BOARD BAG RACE 12'6" £165  
BOARD BAG RACE 14' £175

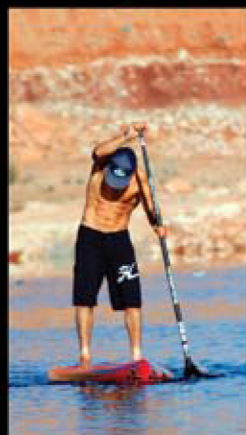
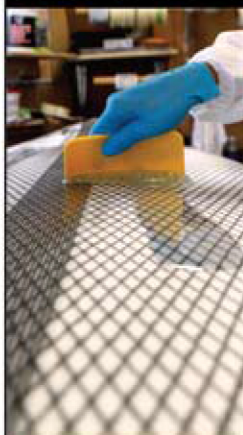

MAKING HIGH QUALITY  
HIGH PERFORMANCE  
BOARDS IS SOMETHING  
WE HAVE DONE FOR  
OVER 62 YEARS

 **HOBIE**  
STAND UP PADDLEBOARDS



**DISTRIBUTOR**

THE HOBIE CENTRE, ROCKLEY PARK, POOLE, BH15 4LZ

[WWW.HOBIECENTRE.CO.UK](http://WWW.HOBIECENTRE.CO.UK)

TEL: 01202 671661

EMAIL: [KRIS@HOBIECENTRE.CO.UK](mailto:KRIS@HOBIECENTRE.CO.UK)