

Gallery tours

Enjoy an insightful and free 60-minute tour with a voluntary guide.

Where: depart from main foyer

When: hourly,
10.30 am – 2.30 pm

Special exhibition tours operate regularly and are included in the ticket price. Ask our friendly Visitor Experience Team at the front desk for departure times.

Cafés

Grab a bite to eat and relax in one of our cafés. Takeaway food and drink is also available for consumption outside of the Gallery. Members receive a 10% discount.

Gallery Café

Where: Lower ground floor

When: 10.00 am – 4.00 pm daily

Street Café

Where: outside the main entry
When: hours change seasonally so check with our friendly Visitor Experience Team at the front desk

Gallery Shop

Spoil yourself or find the perfect gift for someone special. Choose from the extensive range of books, prints, homewares, jewellery and children's gifts. Members receive a 10% discount.

Where: Level 1

Art outside

The collection continues outside the building, with highlights including:

Fujiko Nakaya's fog sculpture

Foggy wake in the desert: An ecosystem.

Where: Sculpture Garden

When: 12.30 – 2.00 pm

James Turrell's skyspace

Within without

Where: Australian Garden

When: Best viewing times are sunset and sunrise – see

nga.gov.au/turrell for exact times.

Membership

Become a member and skip the queues. Enjoy exclusive benefits including discounted tickets, exclusive viewings, Artonview magazine and access to the private Members Lounge with stunning views over the Sculpture Garden. Individual, joint and student memberships available.

Members Lounge

Where: Level 2 Mezzanine

When: 10.15am – 4.30 pm daily

More info:

nga.gov.au/members

Free call 1800 020 068

(Mon-Fri)

Cloakroom

You are welcome to cloak your belongings in our free cloakroom.

Bags measuring 40cms on any side, large umbrellas, monopods and tripods must be cloaked.

To protect the artwork from unintentional damage, please do not carry anything on your back while inside the Gallery.

Where: Ground

Access

The NGA welcomes visitors of all abilities. Accessible parking spaces are located in the Parkes Place underground car park with lift access to the ground floor foyer. A lip curb on Parkes Place provides easy drop off and pick up for people with restricted mobility.

Mobility scooters, wheelchairs, walkers, walking canes and strollers are free for public use inside the Gallery and available through the front desk and cloakroom. Wheelchair accessible toilets are available via a ramp on the ground floor (entry level) and on Level 1.

A program of facilitated tours for people of diverse abilities are available on the NGA website.

Speak to our friendly Visitor Experience Team at the front desk for further assistance.

More info:
nga.gov.au/visiting
(02) 6240 6519



Care for the collection

To keep the collection in beautiful condition, please do not touch the artwork.

We recommend keeping a safe one-metre distance at all times.

While photography is encouraged, the use of flash, selfie sticks and tripods is not permitted. Water may be consumed in the foyer areas only and food and drink is not permitted near artwork.

Gallery Information

National Gallery of Australia

Parkes Place East

Canberra ACT

nga.gov.au

Free general admission

10.00 am – 5.00 pm daily

(Closed Christmas Day)

Enquiries:

information@nga.gov.au

(02) 6240 6411

Group bookings

Education and social groups are exceptionally well catered for at the Gallery. From art discovery tours, focus tours and special exhibition tours, there is something for everyone.

More info:

nga.gov.au/tours

groupbookings@nga.gov.au

Bookings:

bookcanberraexcursions.com.au

Learning at the Gallery

At the Gallery we believe in lifelong learning and provide a quarterly program of events for a range of audiences. From preschool to tertiary education, we offer free programs that spark inspiration and creativity. We also have resources to support teachers and students. Sign up for our Education E-news to stay up to date.

More info:

nga.gov.au/education

nga.gov.au/whatson

Tim Fairfax Learning Gallery and Studio

Body Language, in the Learning Gallery, explores the identity of Australia's diverse Aboriginal and Torres Strait Islander people and communities.

Where: Level 2

Until February 2020

More info:

nga.gov.au/exhibitions

The Studio provides a new space to get creative and hands on, including the free Open Studio program of drop in art making every weekend.

More info:

nga.gov.au/whatson

Learning Patron

Tim Fairfax AC

Collection Study Room

The Gallery provides excellent research facilities, including free public access to works of art in the permanent collection that are not currently on display. Popular with special interest groups, the Collection Study Room requires at least three weeks' notice to facilitate viewing requests.

More info:

nga.gov.au/research

CSR@nga.gov.au

Stay informed

Subscribe to our monthly *Artonline* and keep an eye on our website to discover what's happening at the Gallery and which travelling exhibitions are coming to a town near you.

More info:

nga.gov.au/artonline

nga.gov.au/calendar

nga.gov.au/exhibitions

Venue hire

The Gallery is home to several unique function spaces in the heart of the national capital.

More info:

(02) 6240 6711

events@nga.gov.au

Visitor Survey

Complete our visitor survey and help us provide you with the best possible experience.

Tell us about your visit at

nga.gov.au/experience

Stay connected



[#nationalgalleryaus](https://www.instagram.com/nationalgalleryaus)

NGA app

Need help finding your way around? Download the free NGA app from iTunes.

Free Wi-Fi



Complimentary Wi-Fi is provided for your convenience.

Gallery Map

NGA National Gallery of Australia



NGA
National Gallery of Australia

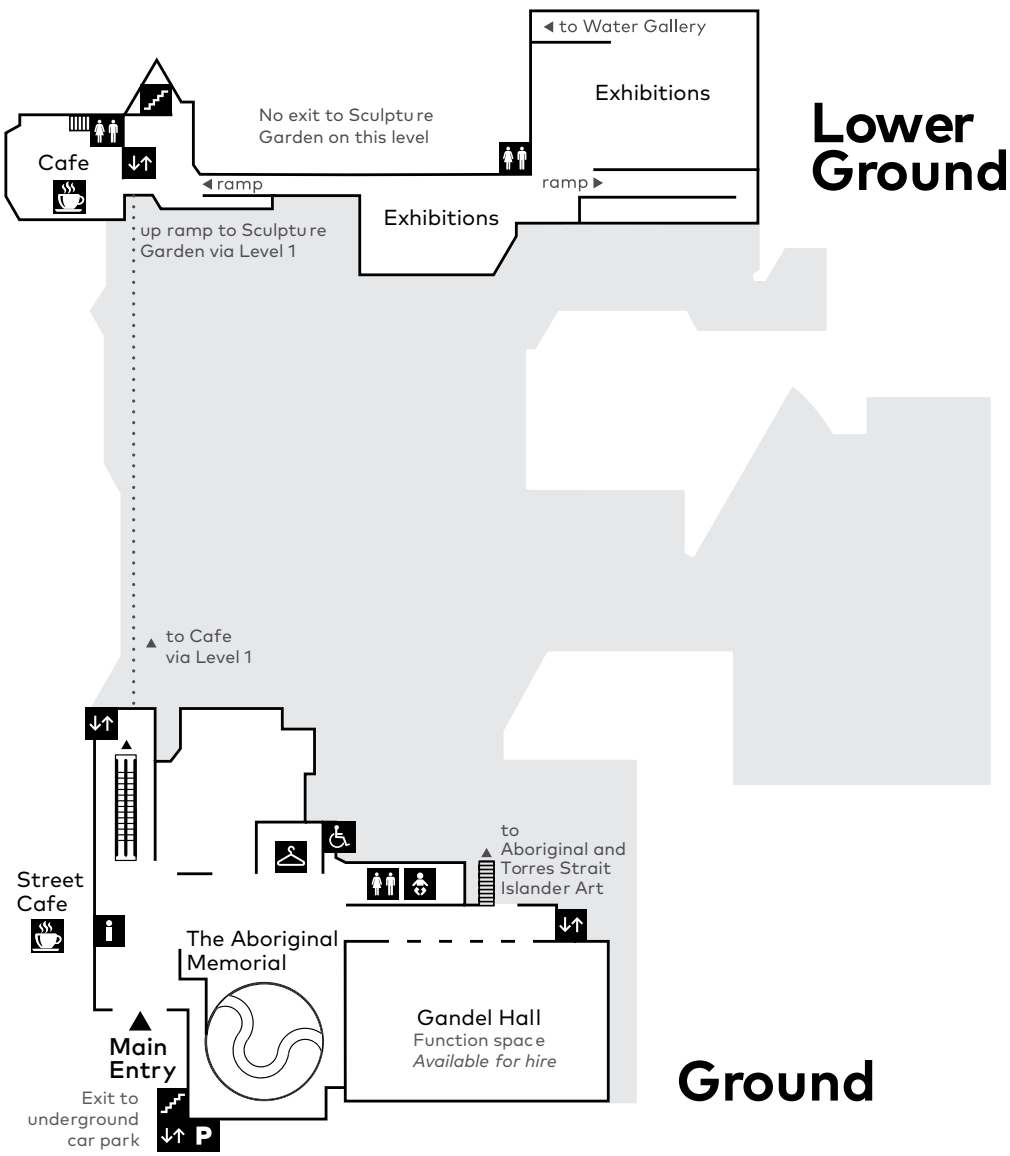

Lower Ground

Ground

Australian Garden

James Turrell
skyspace *Within without*

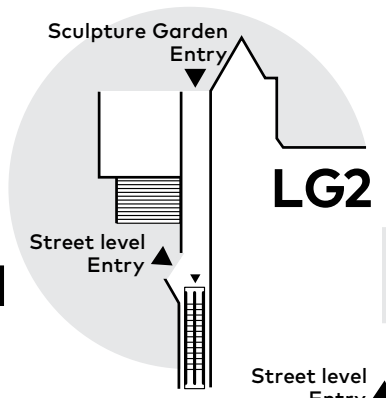

LG2

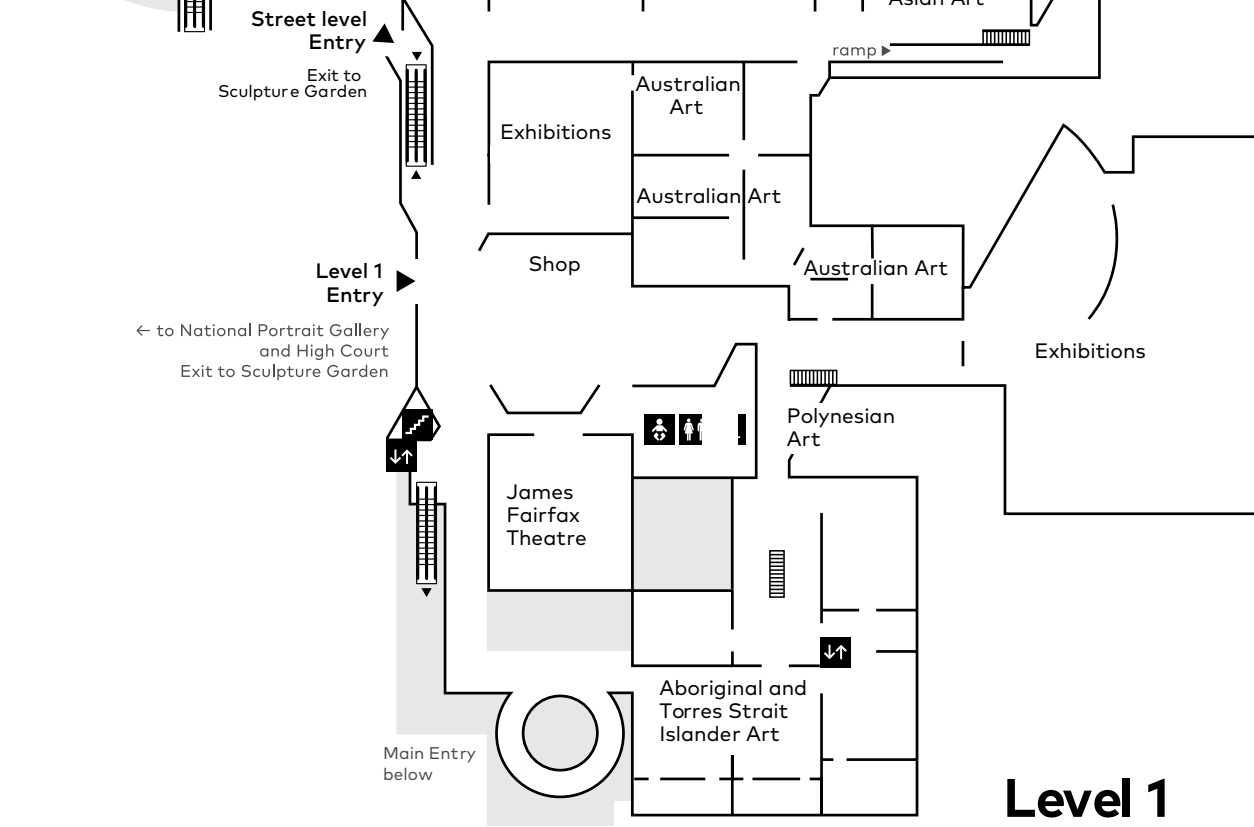

Level 1

- i** Information
- P** Underground car park
- ♿** Toilets
- 🚪** Cloakroom
- 🏠** Stairs
- 🚗** Lift
- ☕** Cafe

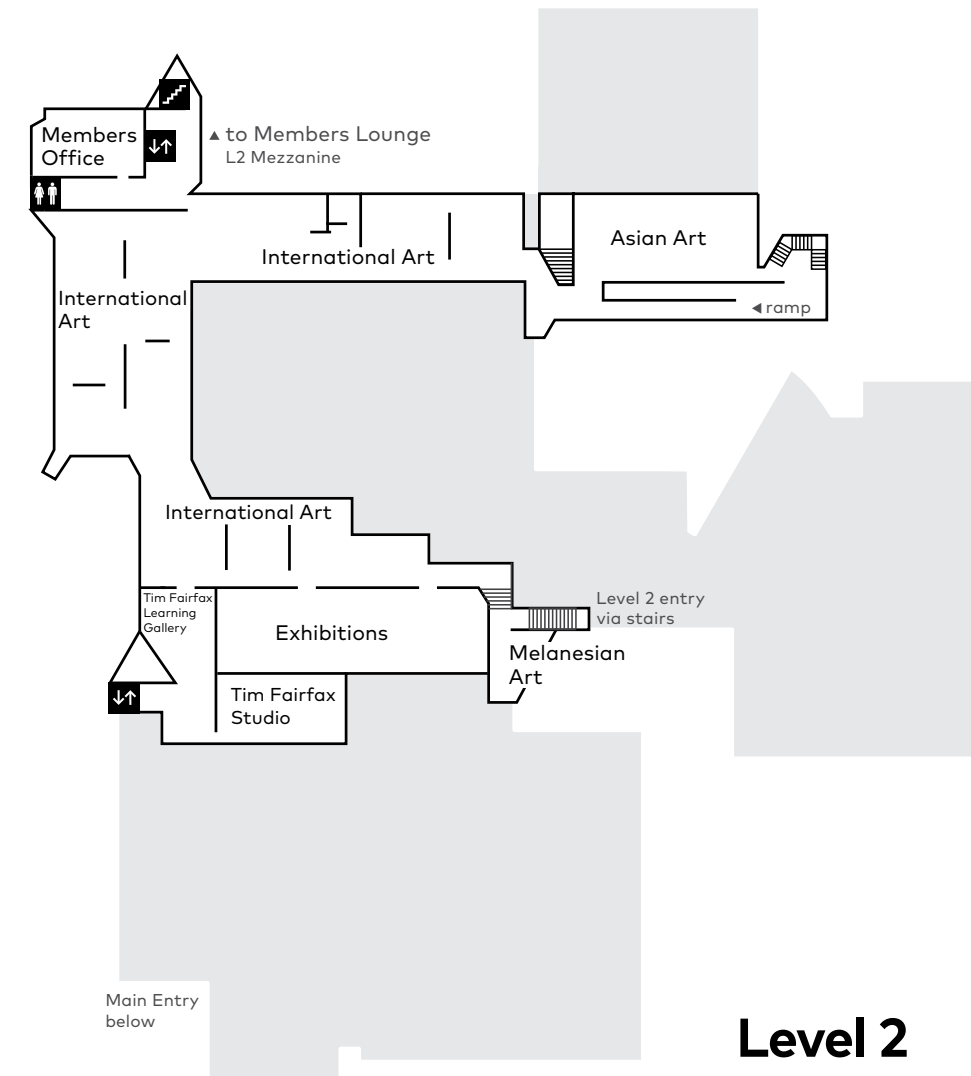

Level 2