

BIODIVERSITY GARDEN PLAN

GLEN WAVERLEY SOUTH PRIMARY SCHOOL

(This is a compilation of student ideas from their sketches /plans and discussions.)

- Work toward attaining ResourceSmart Schools BIODIVERSITY STAR
- Improve kerb appeal of the school
- Educate and involve students

*Continue to construct
ROCK GARDENS
as space allows.*



ACKNOWLEDGE

Traditional land owners

Mosaic flag

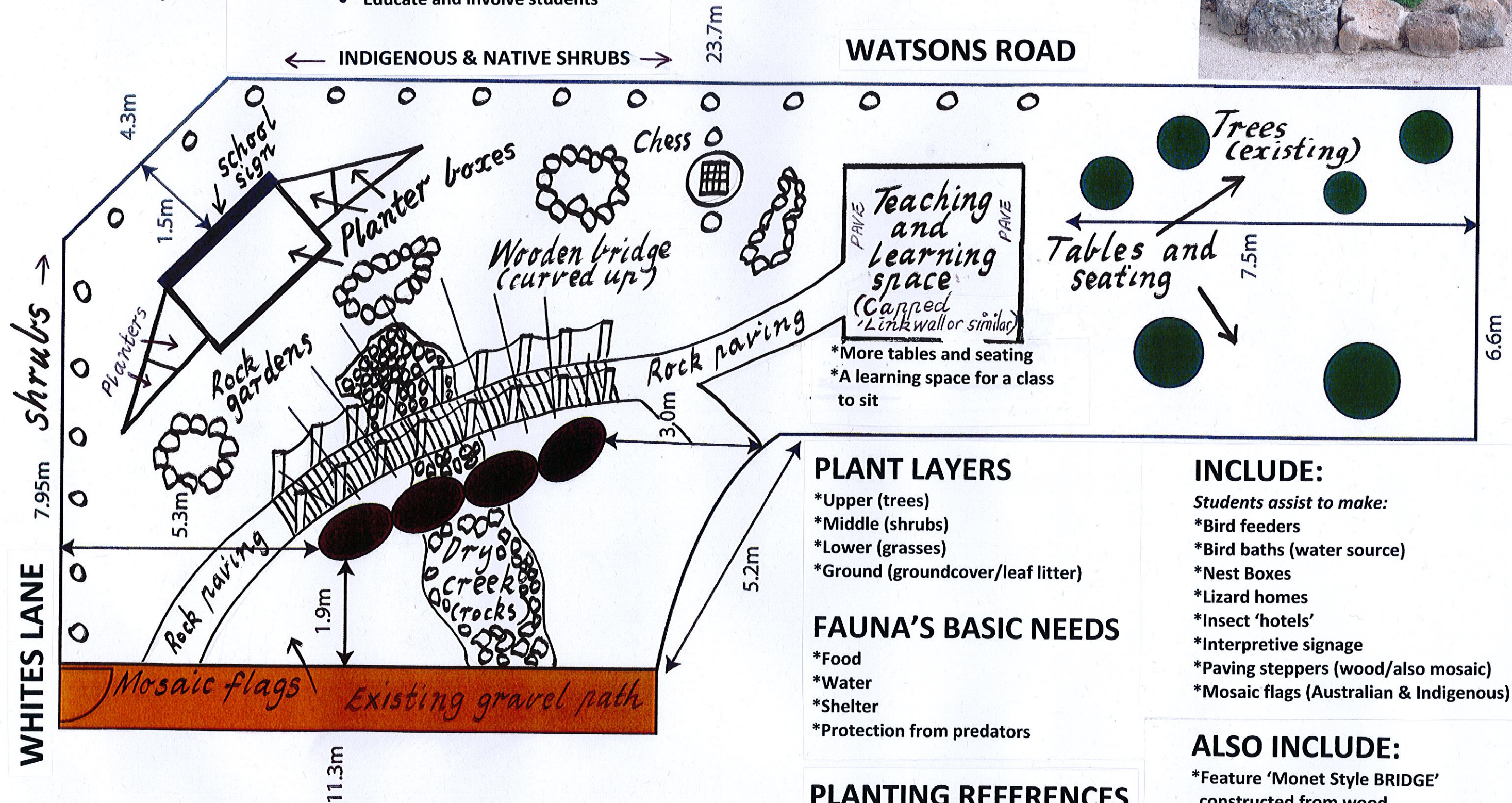

PLANT LAYERS

- *Upper (trees)
- *Middle (shrubs)
- *Lower (grasses)
- *Ground (groundcover/leaf litter)

FAUNA'S BASIC NEEDS

- *Food
- *Water
- *Shelter
- *Protection from predators

PLANTING REFERENCES

- *CITY OF MONASH
'Indigenous Plants of Monash'
- *Kurunga Native Nursery

INCLUDE:

- Students assist to make:*
- *Bird feeders
 - *Bird baths (water source)
 - *Nest Boxes
 - *Lizard homes
 - *Insect 'hotels'
 - *Interpretive signage
 - *Paving steppers (wood/also mosaic)
 - *Mosaic flags (Australian & Indigenous)

ALSO INCLUDE:

- *Feature 'Monet Style BRIDGE' constructed from wood
- *Dry creek bed
- *Some tables tiled to be chess boards

EXISTING FENCED SUSTAINABILITY GARDEN

- 7 RAISED GARDEN BEDS
- TEACHING AND LEARNING SPACE (TURF/SHADE SAIL)