

# *The SSQ275 New Lock Panel Program:*

*The proprietary panel system that can be snap-locked and seamed!*

*Patent(s) Pending*

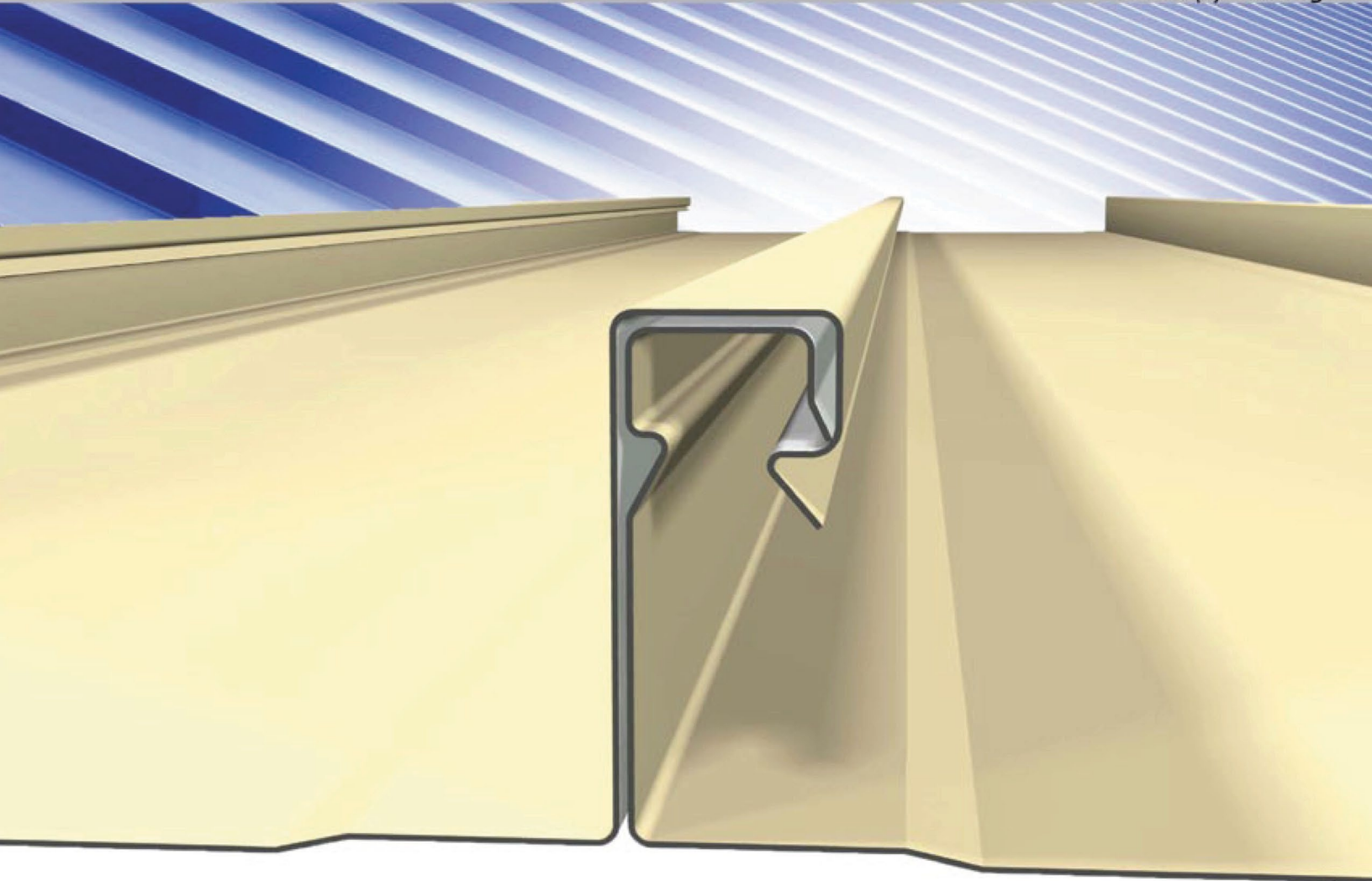

*Brought to you by:*



**New Tech Machinery**

**New Tech Machinery**

[www.NewTechMachinery.com](http://www.NewTechMachinery.com)

[Info@NewTechMachinery.com](mailto:Info@NewTechMachinery.com)

1-800-574-1717



**Karrs Building Supply**

[www.KBSRollformers.com](http://www.KBSRollformers.com)

[Ron@KBSRollformers.com](mailto:Ron@KBSRollformers.com)

713-263-1522

# SSQ275 New Lock Panel Program

New Tech Machinery (NTM), founded in 1991, is the the world-wide industry leader in portable rollforming equipment. We are very proud to announce our latest innovation, **THE SSQ New Lock 275 Panel Program!** We've partnered with our long-time trusted distributor, Karr's Building Supply (KBS), in this new venture.

## STANDARD FEATURES

- |  |  |
|--|--|
| • Proprietary panel system                         | • 2" tall finished panel                                 |
| • Can be snap-locked and mechanically seamed       | • Ease of installation                                   |
| • Fits in new and existing SSQ roof panel machines | • Only available through NTM or KBS                      |
| • Added seam strength due to snap-lock/seam design | • ASTM and UL testing available with purchased licensing |
| • Licensing Agreement Valid for 3 years            | •  |

## OVERVIEW

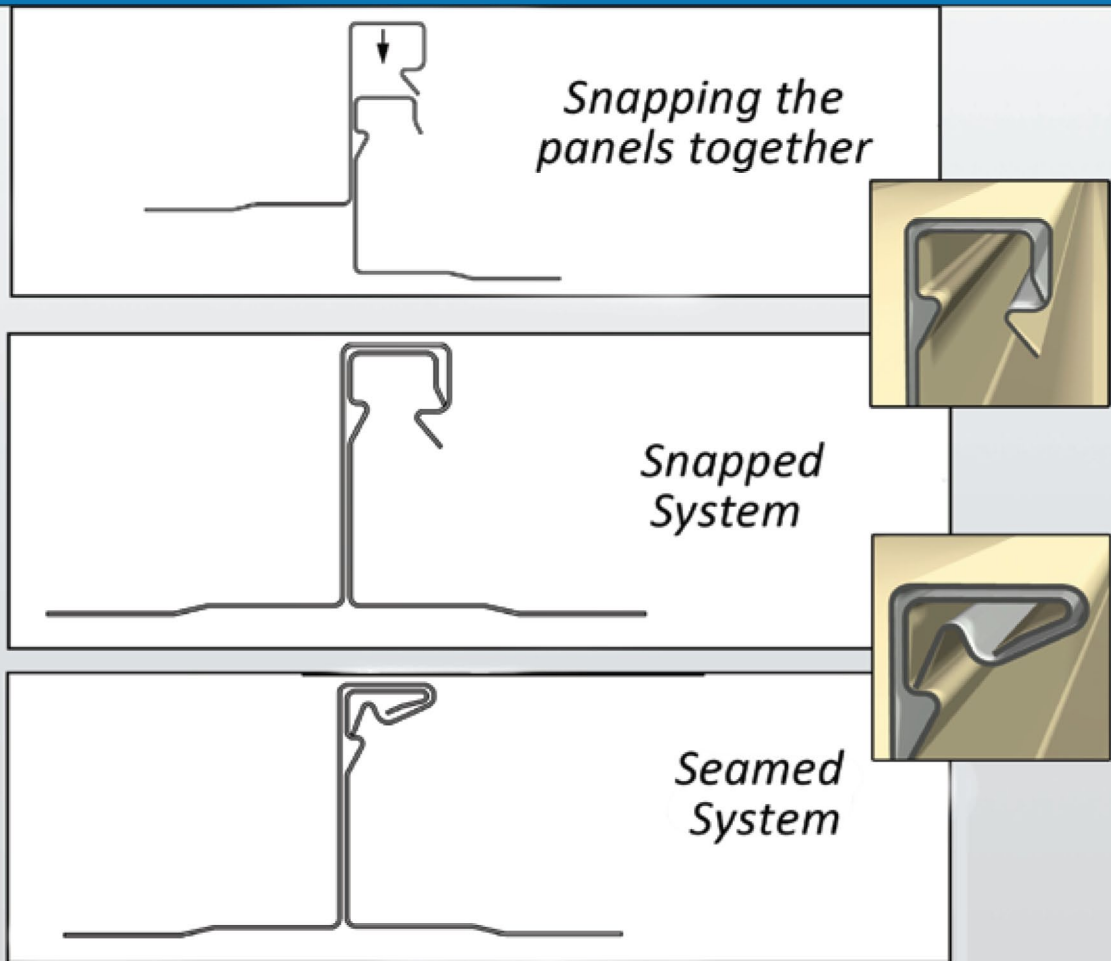

092014

Patent(s) Pending

### New Tech Machinery

1300 40th Street | Denver, CO 80205  
303-294-0538 | 800-574-1717 | Fax: 303-294-9407  
www.NewTechMachinery.com

### Karr's Building Supply

4939 Milwee St. Unit D | Houston, TX 77092  
713-263-1522 | Fax: 713-263-1523  
www.KBSRollformers.com