



flight



Android Developer Options

Andrea Falcone

Senior Software Engineer, Fabric
@asfalcone

You Are Now a Developer!

Agenda

- Debugging UI
- Debugging Performance
- Debugging Crashes

Debugging UI

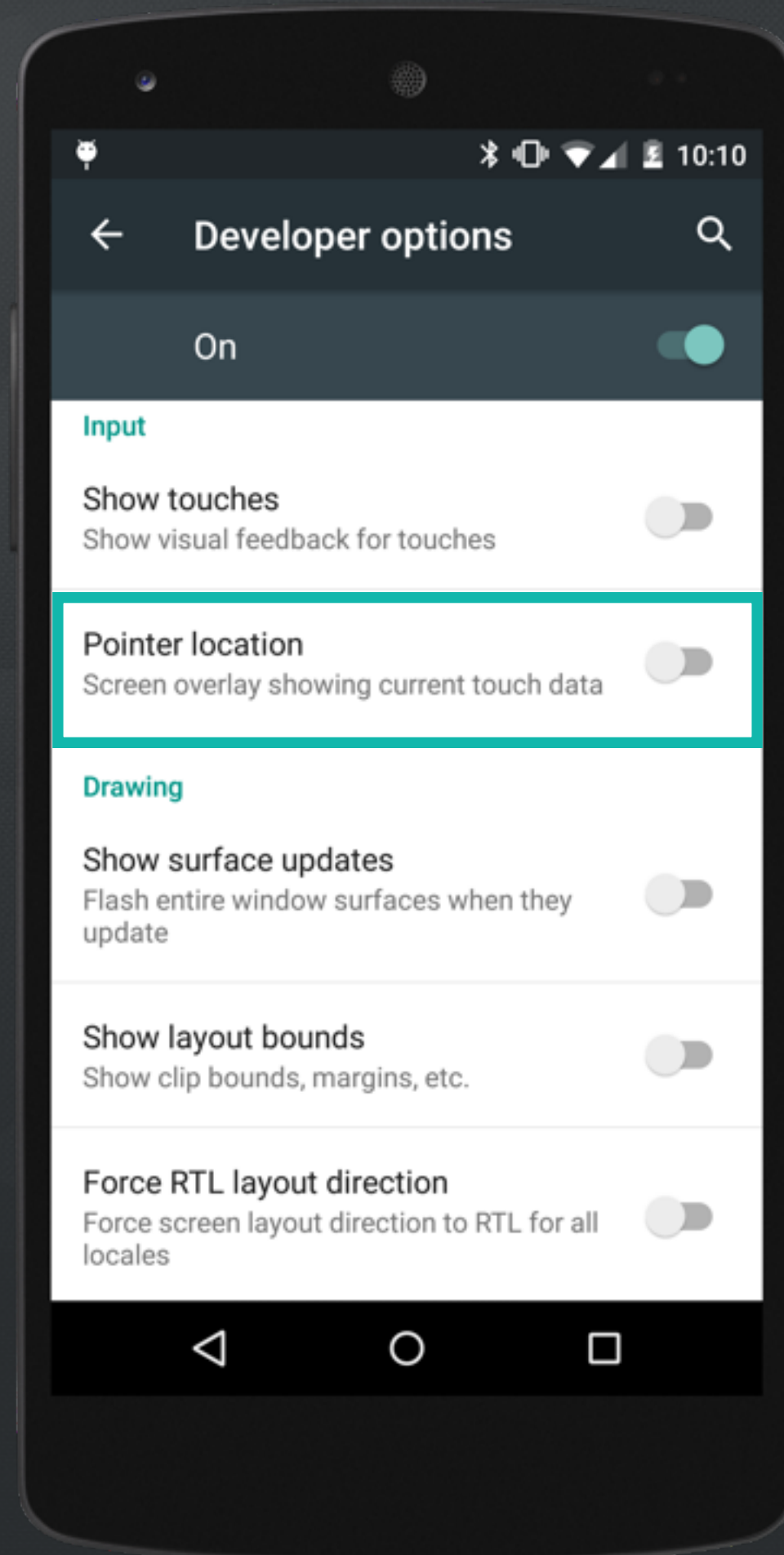



Developer options



On



Always allow Wi-Fi Roam Scans



Logger buffer sizes
256K per log buffer

Input

Show touches
Show visual feedback for touches



Pointer location
Screen overlay showing current touch data



Drawing

Show surface updates
Flash entire window surfaces when they update





Developer options



On



Always allow Wi-Fi Roam Scans



Logger buffer sizes
256K per log buffer

Input

Show touches
Show visual feedback for touches



Pointer location
Screen overlay showing current touch data



Drawing

Show surface updates
Flash entire window surfaces when they update





Developer options



On



Always allow Wi-Fi roaming scans

Logger buffer sizes

256K per log buffer

Input

Show touches

Show visual feedback for touches



Pointer location

Screen overlay showing current touch data



Drawing

Show surface updates

Flash entire window surfaces when they update



Show layout bounds

Show clip bounds, margins, etc.











Show layout bounds

Show clip bounds, margins, etc.



P: 0 / 1   dX: -305.0 dY: -16.0 Xv: 0.890 Yv: 0.735      Prs: 0.60 Size: 0.27 10:21

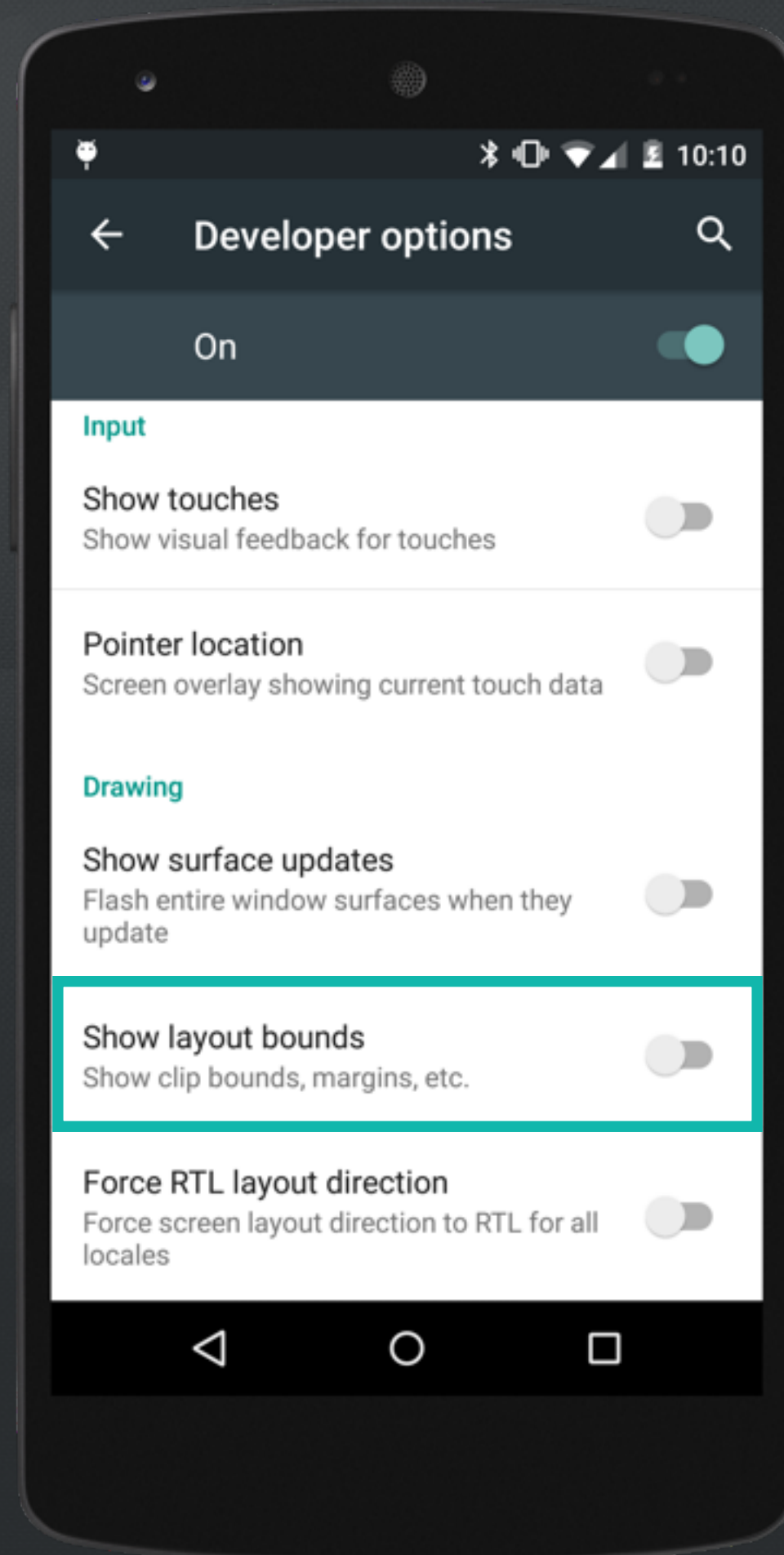

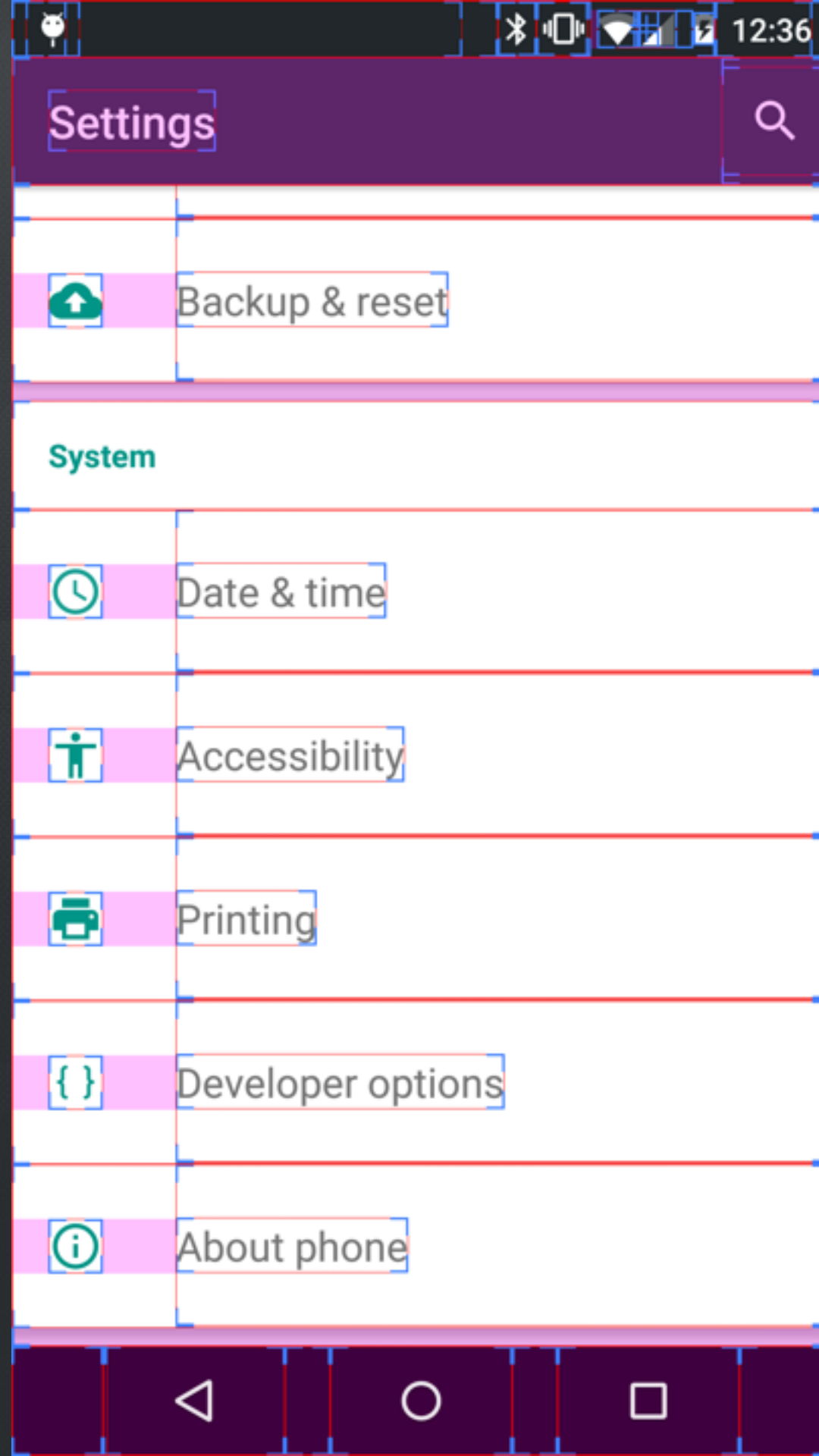

Margins

Optical bounds

Clip bounds

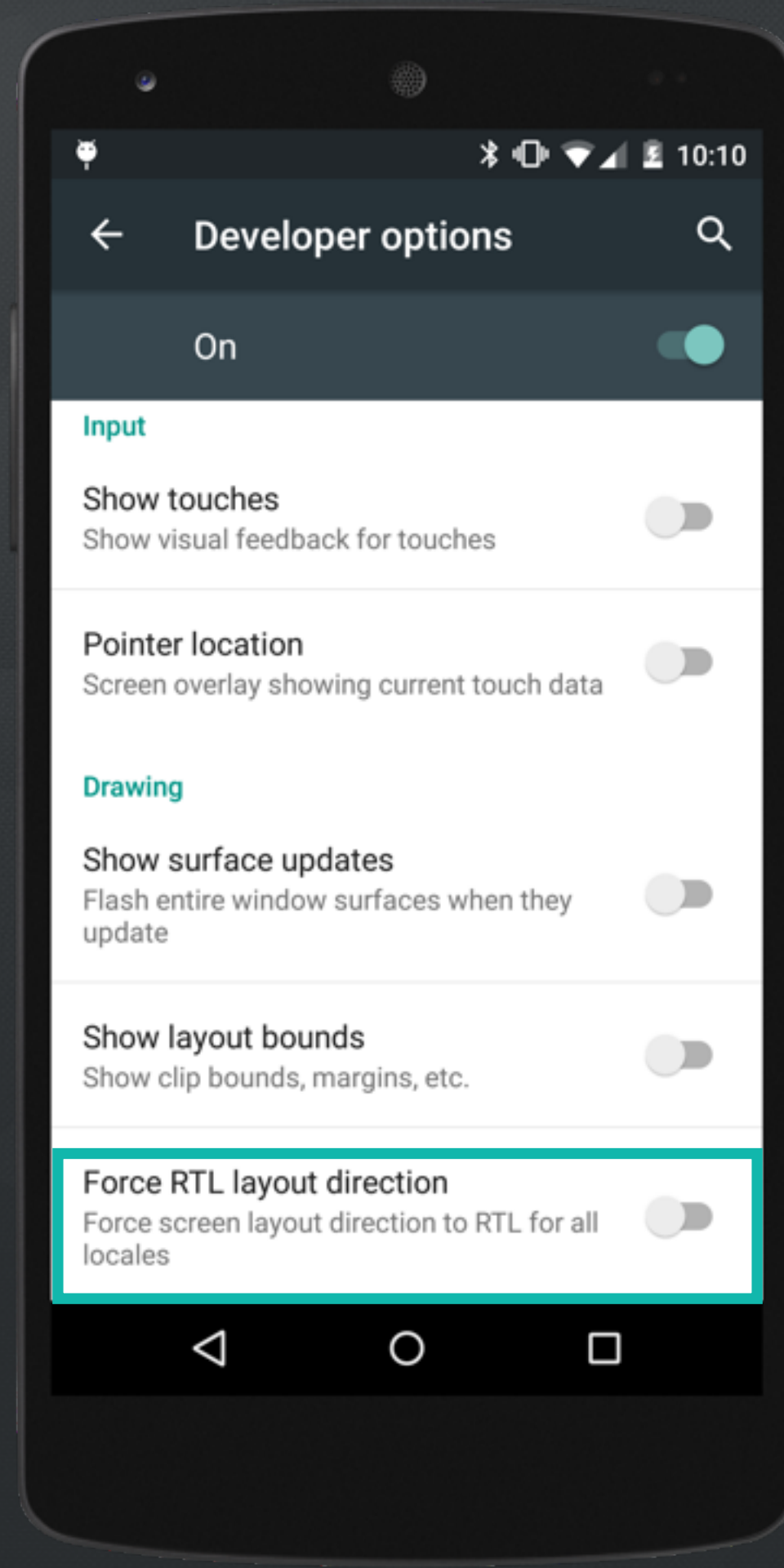

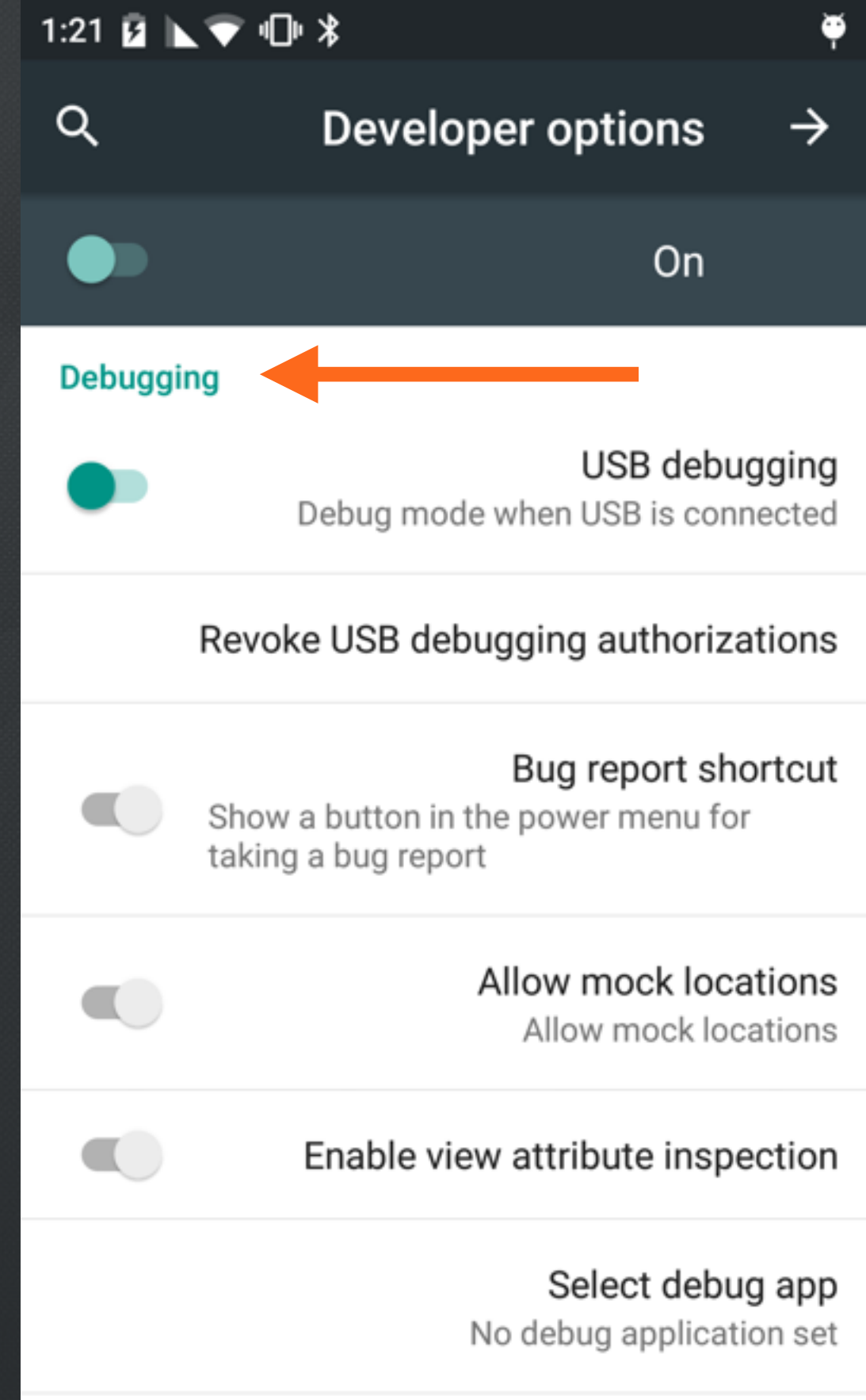
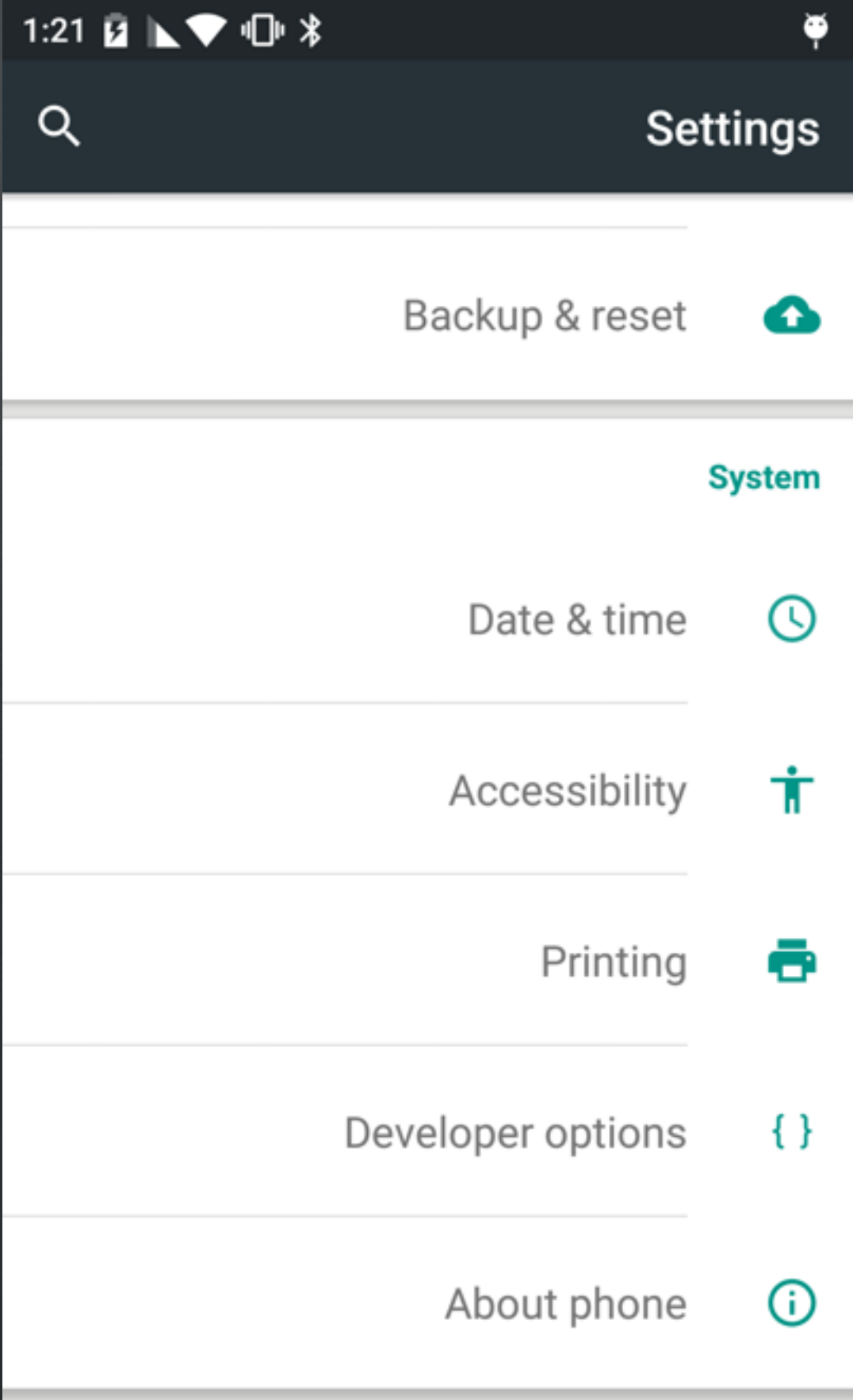

Debugging Performance

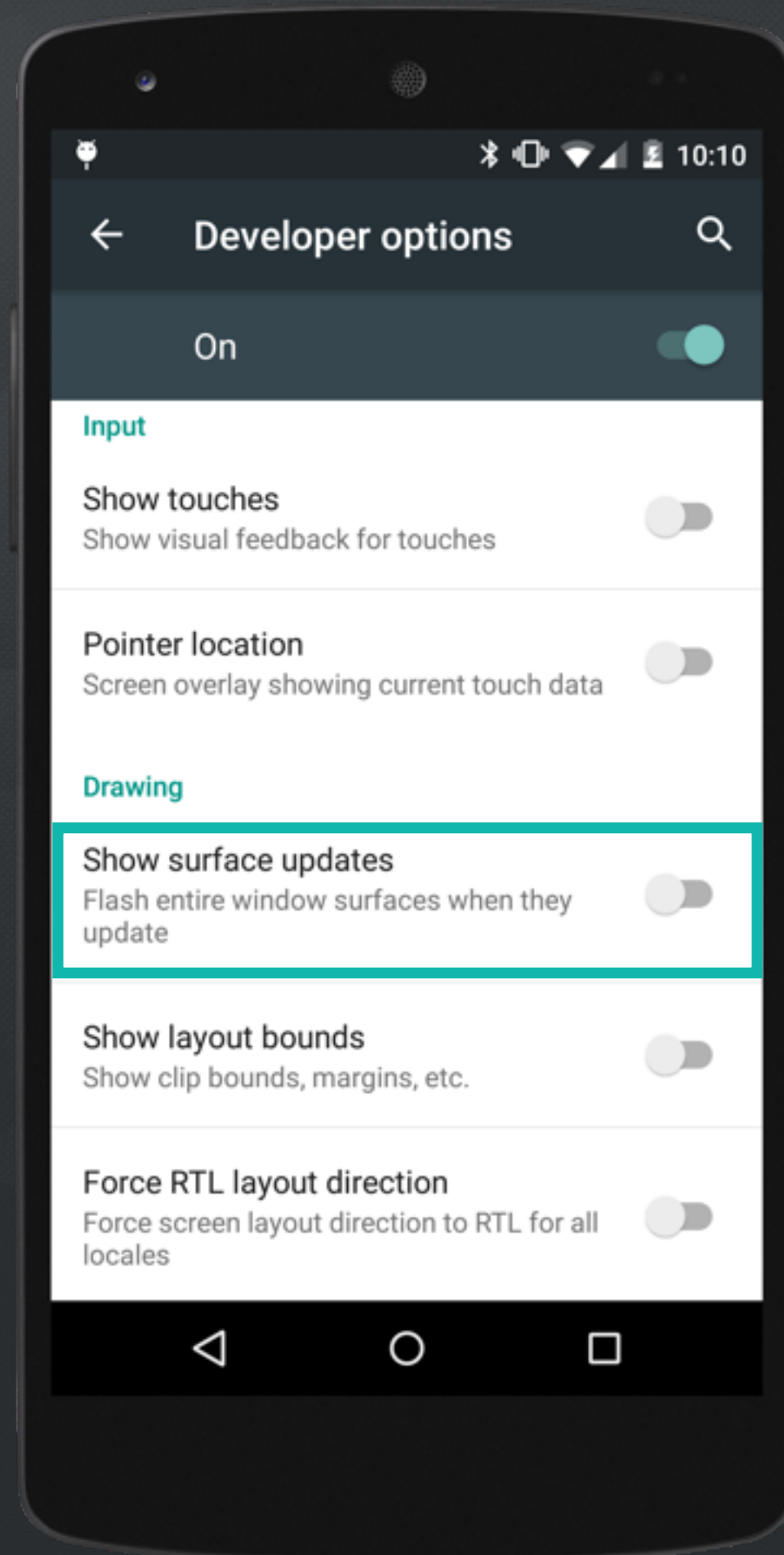

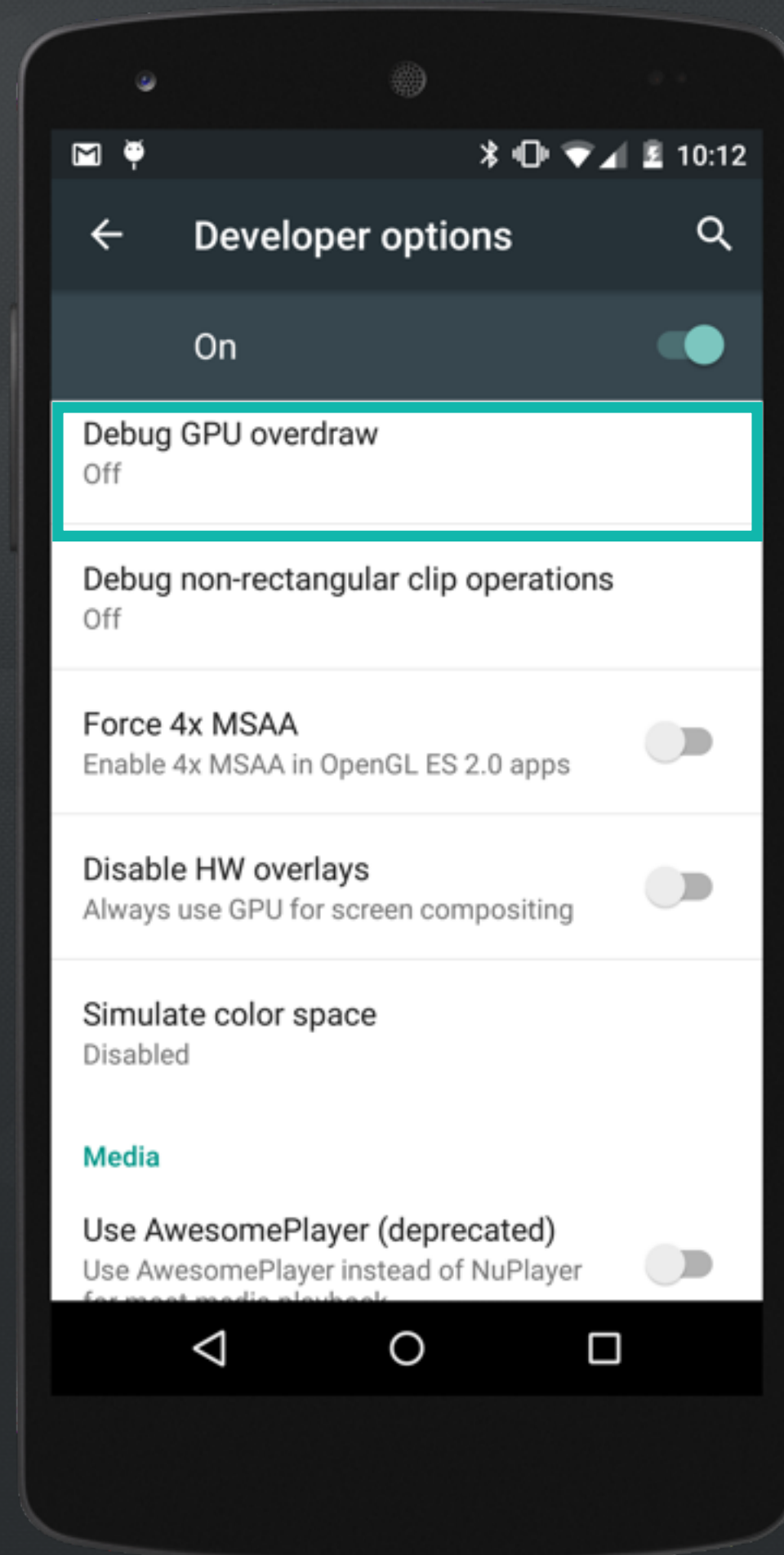

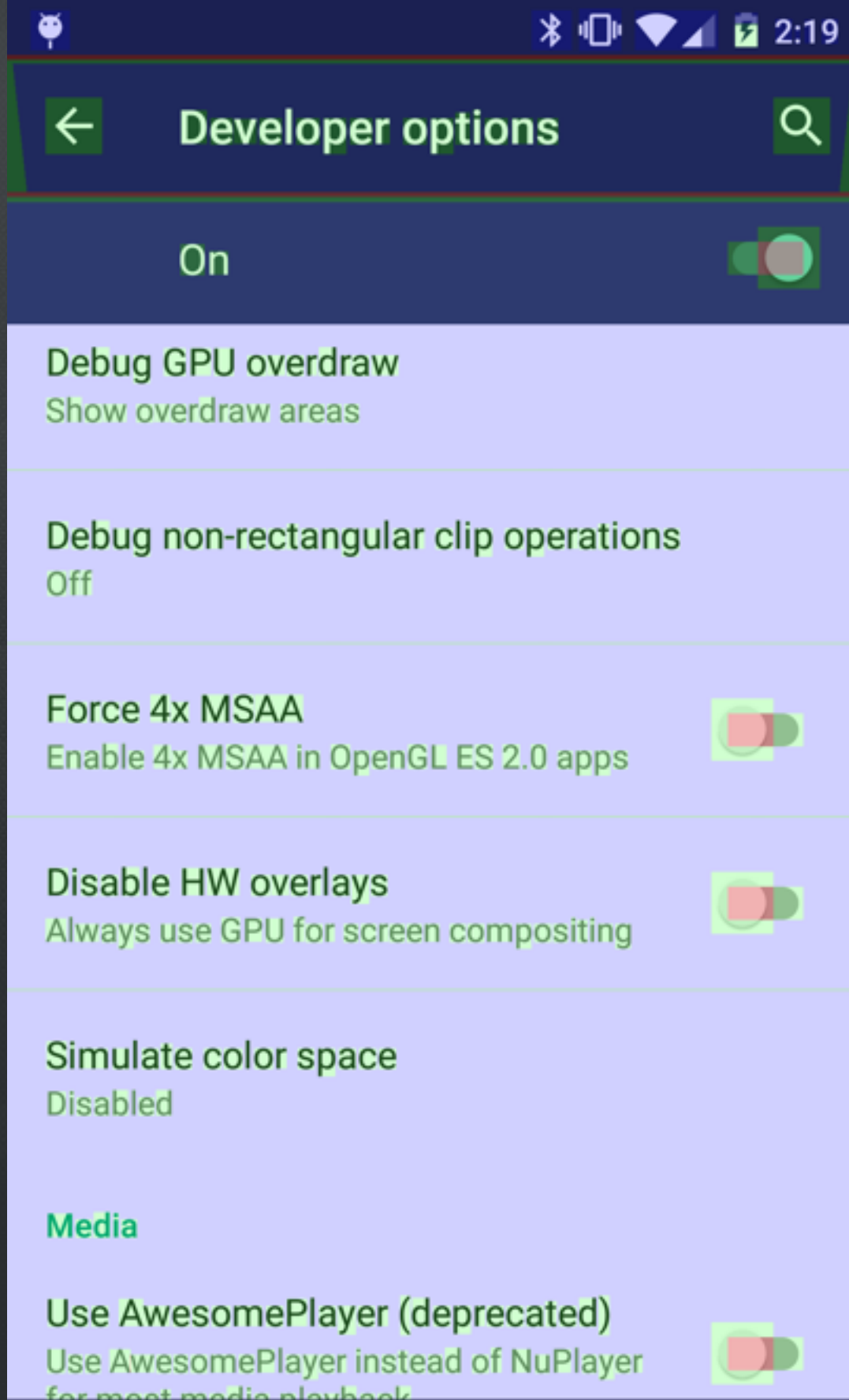

No overdraw

1x overdraw

2x overdraw

3x overdraw

4+x overdraw

Debugging Crashes

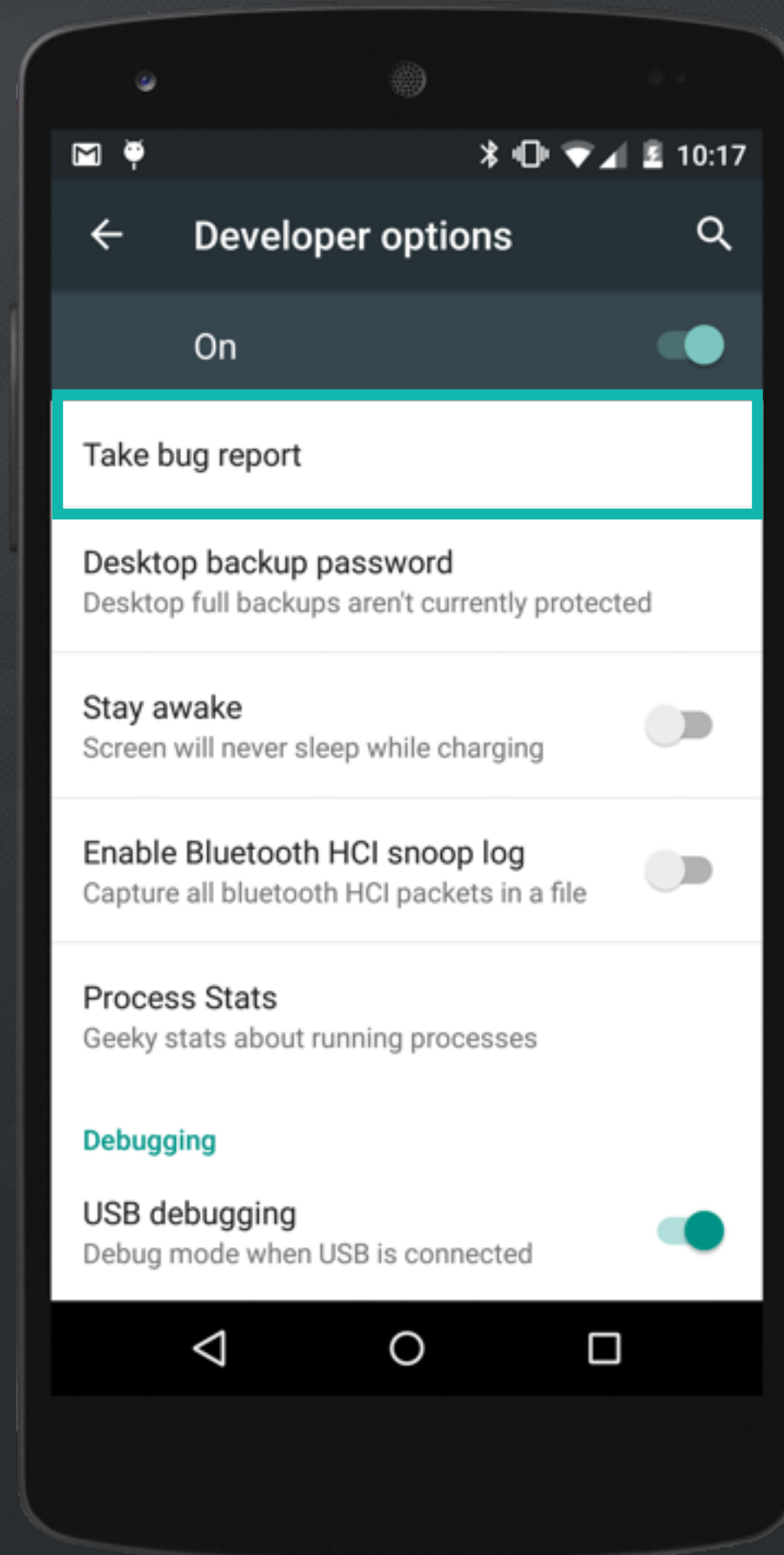

Developer options

On

Take bug report

Take bug report

This will collect information about your current device state, to send as an e-mail message. It will take a little time from starting the bug report until it is ready to be sent; please be patient.

CANCEL REPORT

Process Stats

Geeky stats about running processes

Debugging

USB debugging

Debug mode when USB is connected

```
=====
== dumpstate: 2015-08-04 21:58:08
=====

Build: LMY48B
Build fingerprint: 'google/hammerhead/hammerhead:5.1.1/LMY48B/1863243:user/release-keys'
Bootloader: HHZ12h
Radio: msm
Network: AT&T
Kernel: Linux version 3.4.0-gbebb36b (android-build@vpbs1.mtv.corp.google.com) (gcc version 4.7 (GCC) ) #1 SMP PREEMPT
Tue Mar 10 18:17:45 UTC 2015
Command line: console=ttyHSL0,115200,n8 androidboot.hardware=hammerhead user_debug=31 maxcpus=2 msm_watchdog_v2.enable=1
uart_console=enable gpt=enable lge.kcal=0|0|0|x lge.rev=rev_11 androidboot.laf androidboot.emmc=true
androidboot.serialno=02babba909118bc8 androidboot.bootloader=HHZ12h androidboot.baseband=msm bootreason=power_on
androidboot.hardware.sku=D820 androidboot.hardware.ldr=hynix androidboot.hardware.display=orise

----- UPTIME (uptime) -----
up time: 12 days, 10:08:53, idle time: 3 days, 20:48:12, sleep time: 8 days, 20:53:05
[uptime: 0.100s elapsed]

----- MMC PERF (/sys/block/mmcblk0/stat) -----
16868066 2922795 1197503561 57465550 9632411 11145884 248751740 112926170 0 25330280 170363960

----- MEMORY INFO (/proc/meminfo) -----
MemTotal: 1900556 kB
MemFree: 336372 kB
Buffers: 6836 kB
Cached: 495724 kB
SwapCached: 0 kB
Active: 871836 kB
Inactive: 403068 kB
Active(anon): 775808 kB
Inactive(anon): 42756 kB
Active(file): 96028 kB
Inactive(file): 360312 kB
Unevictable: 1340 kB
Mlocked: 28 kB
HighTotal: 1158144 kB
HighFree: 62464 kB
```

```
UPTIME (uptime)
MMC PERF (/sys/block/mmcblk0/stat)
MEMORY INFO (/proc/meminfo)
CPU INFO (top -n 1 -d 1 -m 30 -t)
PROCESSES (ps -P)
PROCESSES AND THREADS (ps -t -p -P)
APP ACTIVITIES (dumpsys activity all)
APP SERVICES (dumpsys activity service all)
APP PROVIDERS (dumpsys activity provider all)
SYSTEM LOG (logcat -v threadtime -d *:v)
VM TRACES JUST NOW (/data/anr/traces.txt.bugreport)
```

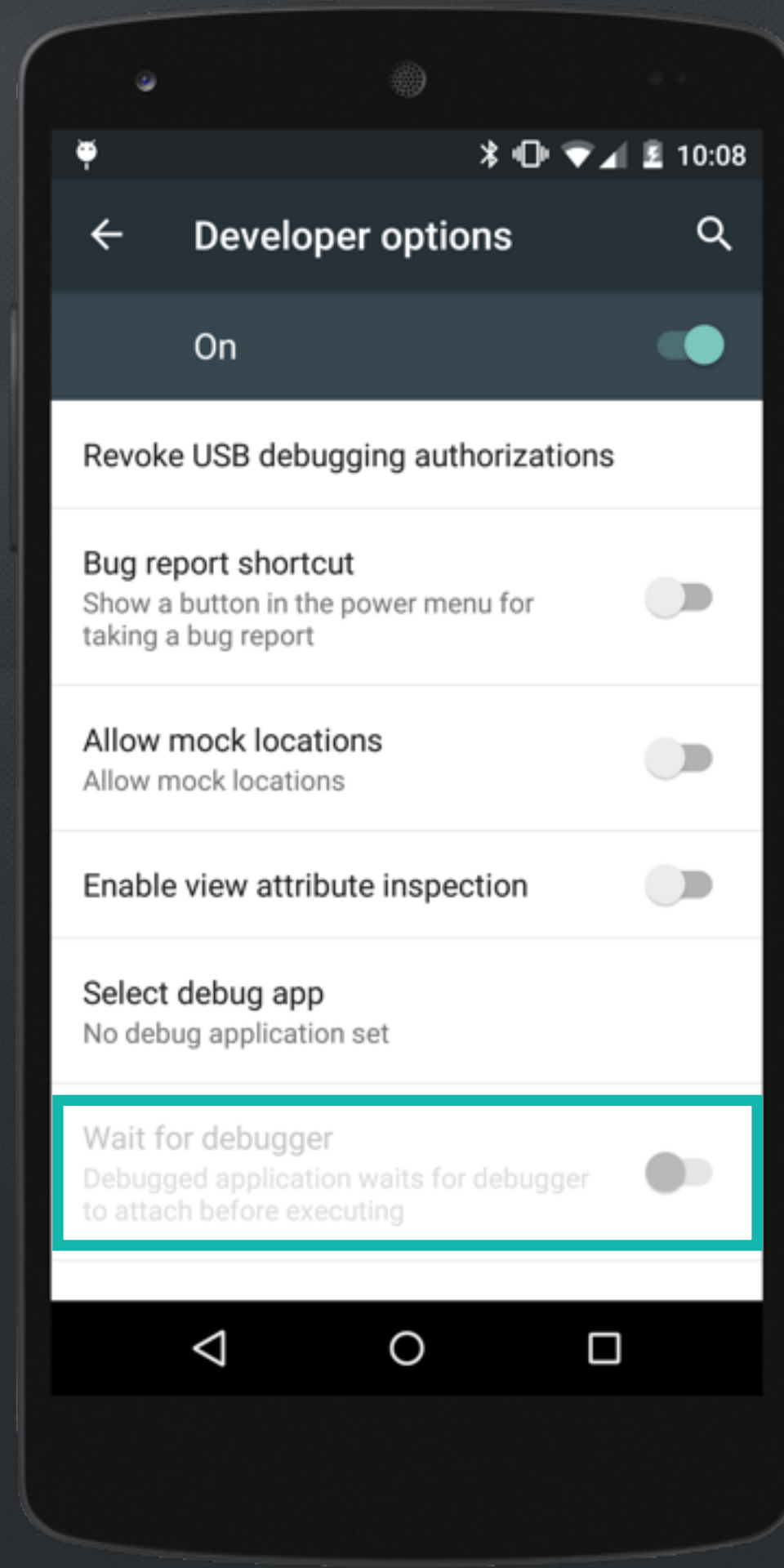
```
protected void onCreate(Bundle savedInstanceState) {  
    super.onCreate(savedInstanceState);  
  
    android.os.Debug.waitForDebugger();  
    int breakpoint = 1;  
}
```

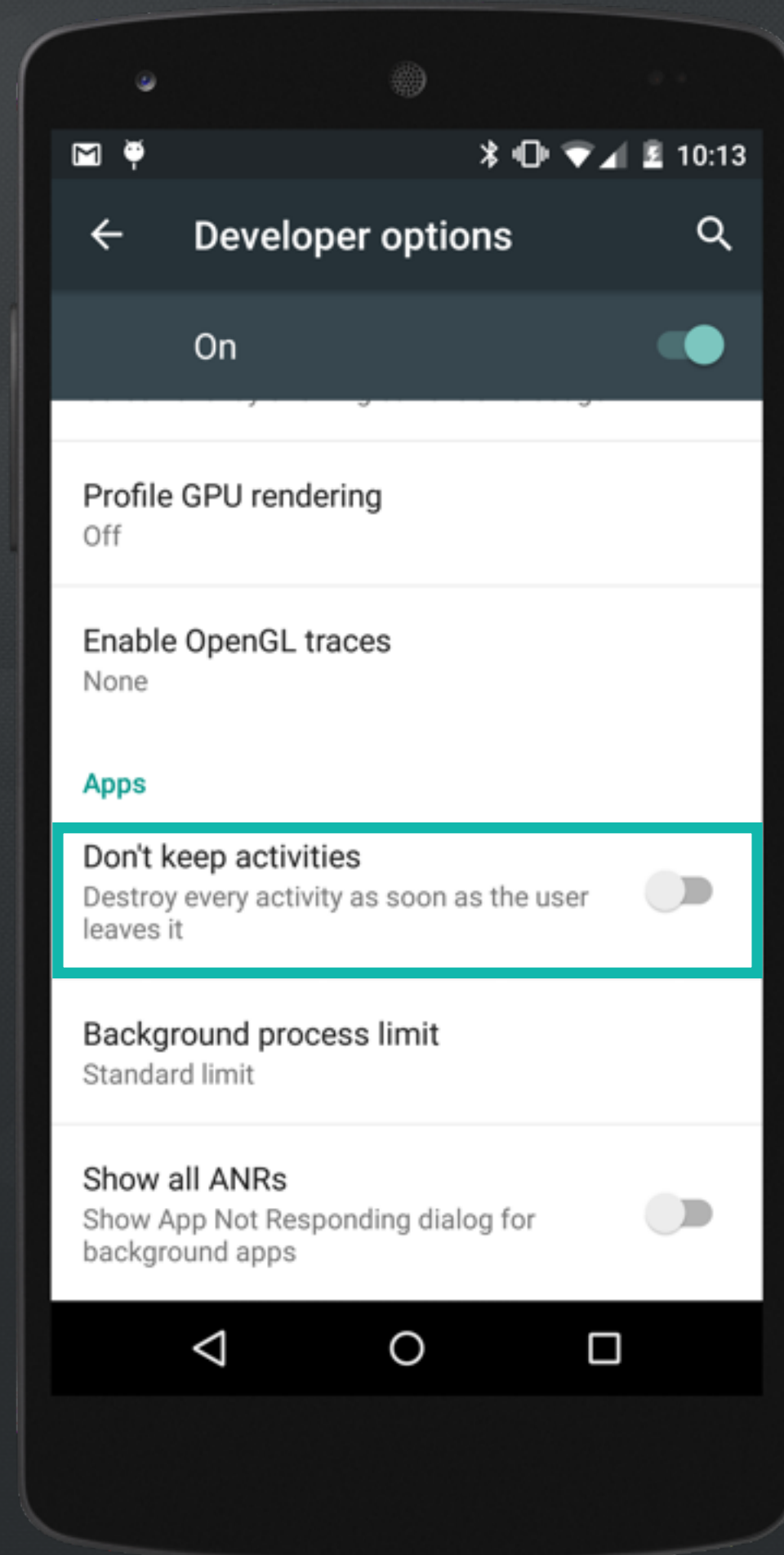

```
protected void onCreate(Bundle savedInstanceState) {  
    super.onCreate(savedInstanceState);  
  
    if (savedInstanceState != null) {  
        // TODO: Find Bugs Here!  
    } else {  
        ...  
    }  
}
```

```
public void onSaveInstanceState(Bundle savedInstanceState) {  
    // TODO: Find Bugs Here!  
    ...  
  
    super.onSaveInstanceState(savedInstanceState);  
}
```

```
public void onRestoreInstanceState(Bundle savedInstanceState) {  
    super.onRestoreInstanceState(savedInstanceState);  
  
    // TODO: Find Bugs Here!  
    ...  
}
```

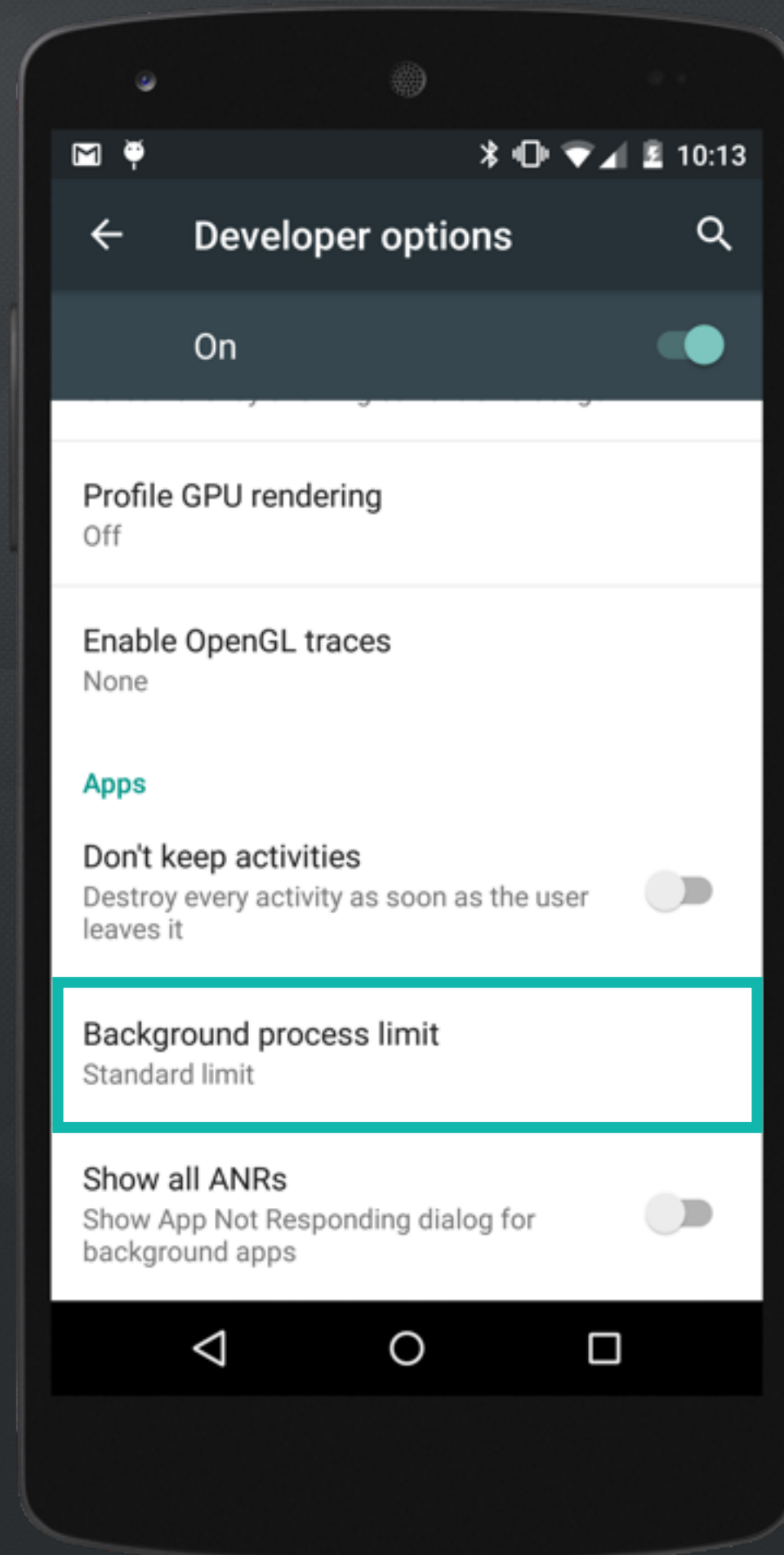

Background process limit

- Standard limit
- No background processes
- At most 1 process
- At most 2 processes
- At most 3 processes
- At most 4 processes

CANCEL

Show all ANRs
Show App Not Responding dialog for background apps

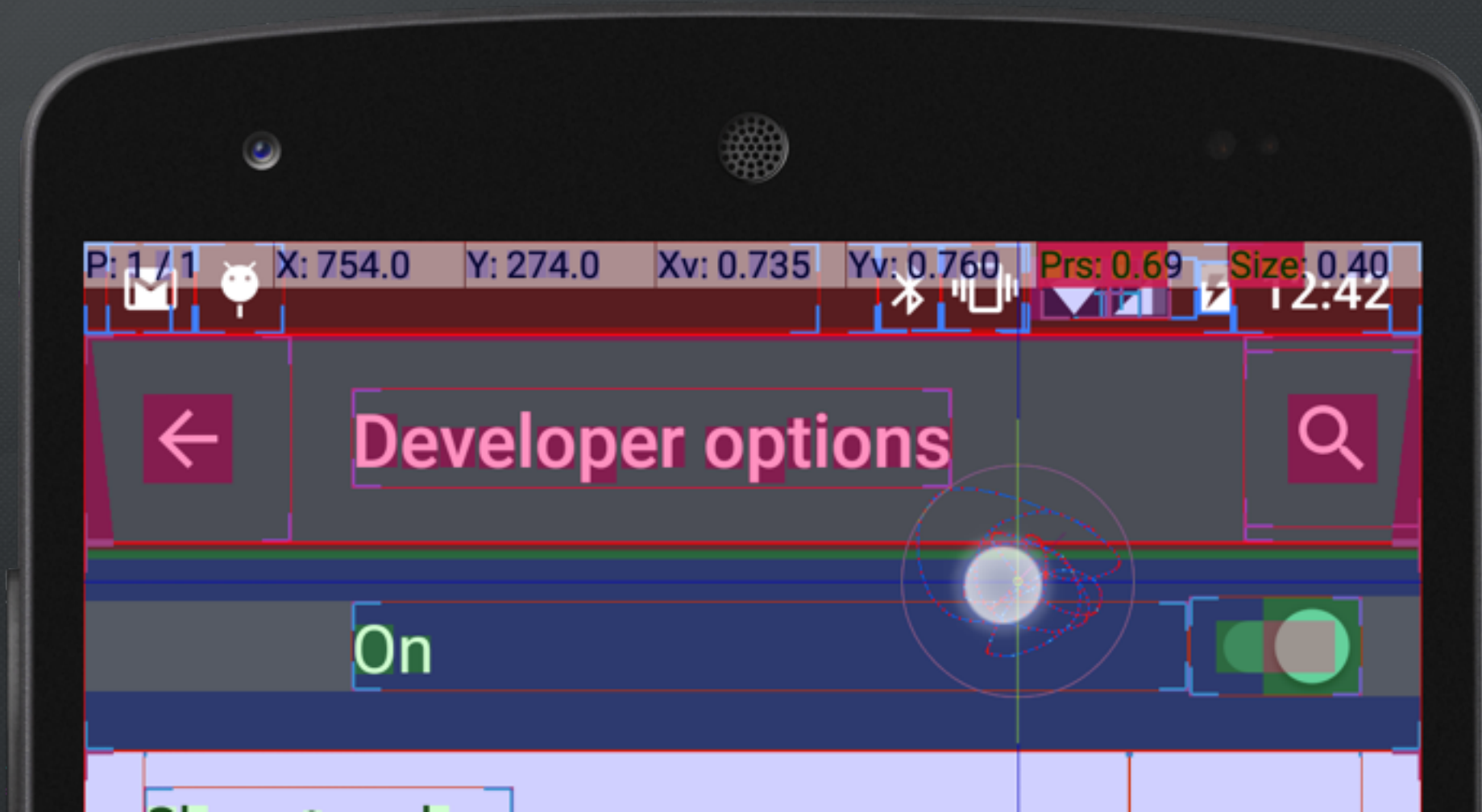



Thank You

@asfalcone