

# First Floor

## Smithsonian American Art Museum

- American Experience
- Folk and Self-taught Art
- Special Exhibitions

## National Portrait Gallery

- Special Exhibitions
- American Origins, 1600–1900
- One Life
- Recent Acquisitions

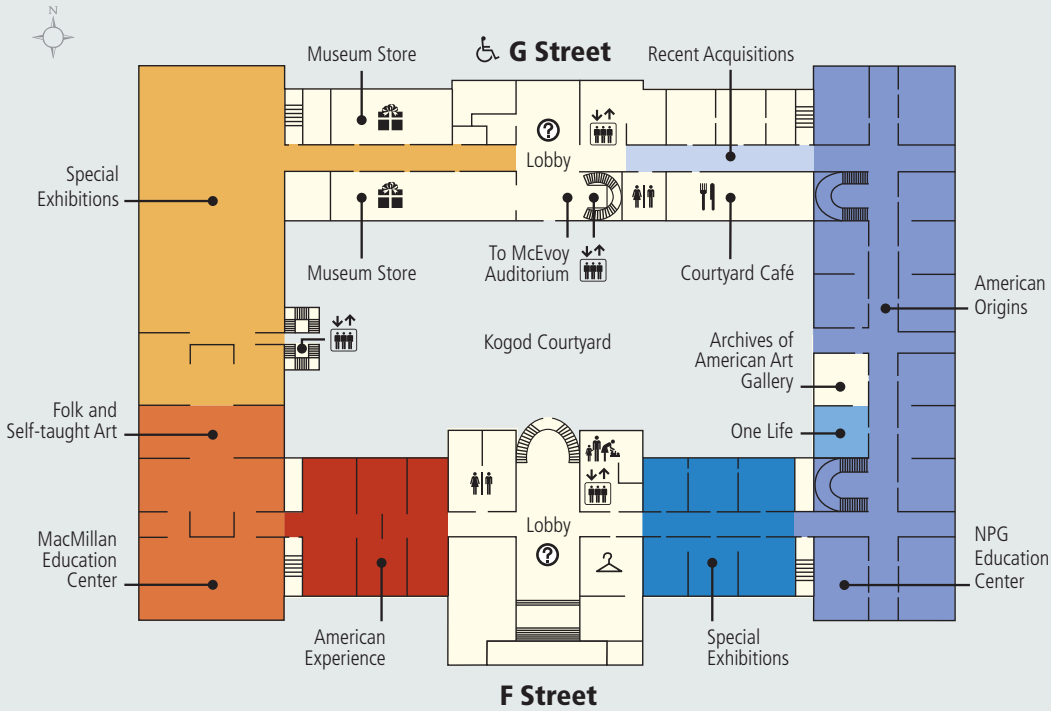

■ American Experience



■ Folk and Self-taught Art

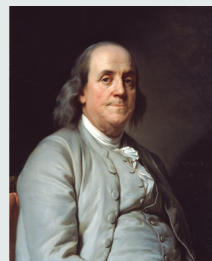

■ American Origins



■ American Origins

# Second Floor

## National Portrait Gallery

- America's Presidents
- The Struggle for Justice
- Portrait Connection
- Special Exhibitions

## Smithsonian American Art Museum

- Graphic Arts
- American Art through 1940

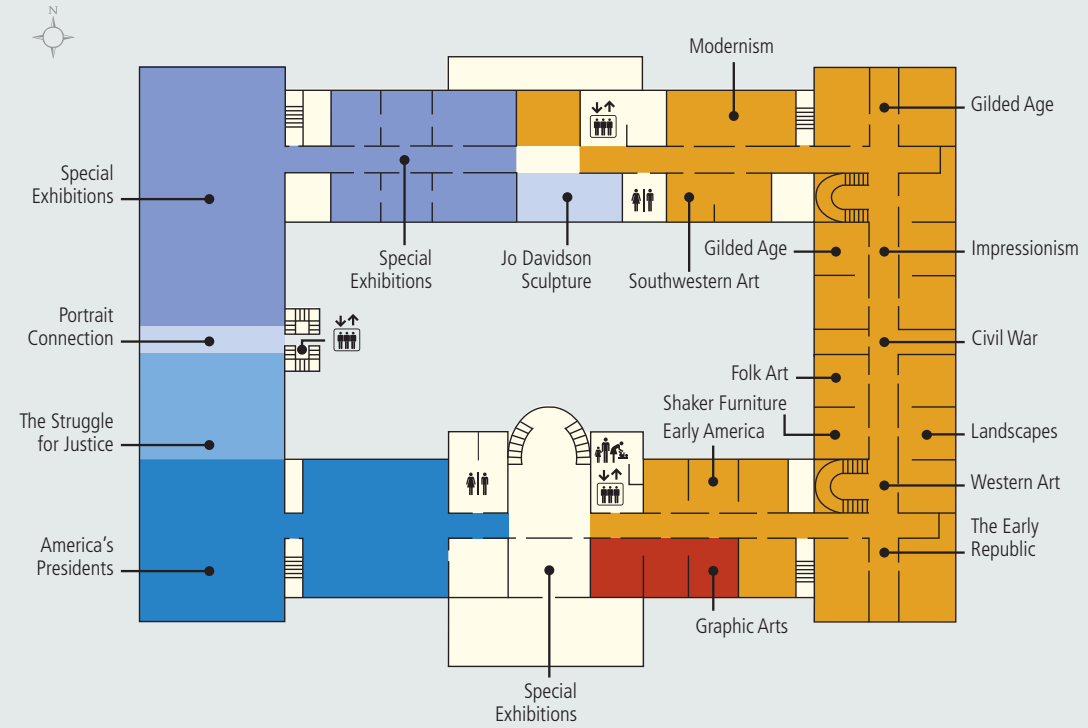

■ America's Presidents

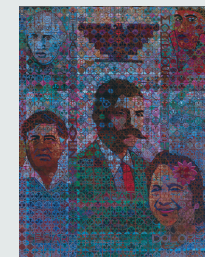

■ The Struggle for Justice



■ Modernism



■ Impressionism

## Third Floor

### Smithsonian American Art Museum

- Luce Foundation Center (Public Study/Art Storage Center)
- Special Exhibitions
- Art Since 1945
- Contemporary Art

### National Portrait Gallery

- Twentieth-Century Americans
- Great Hall

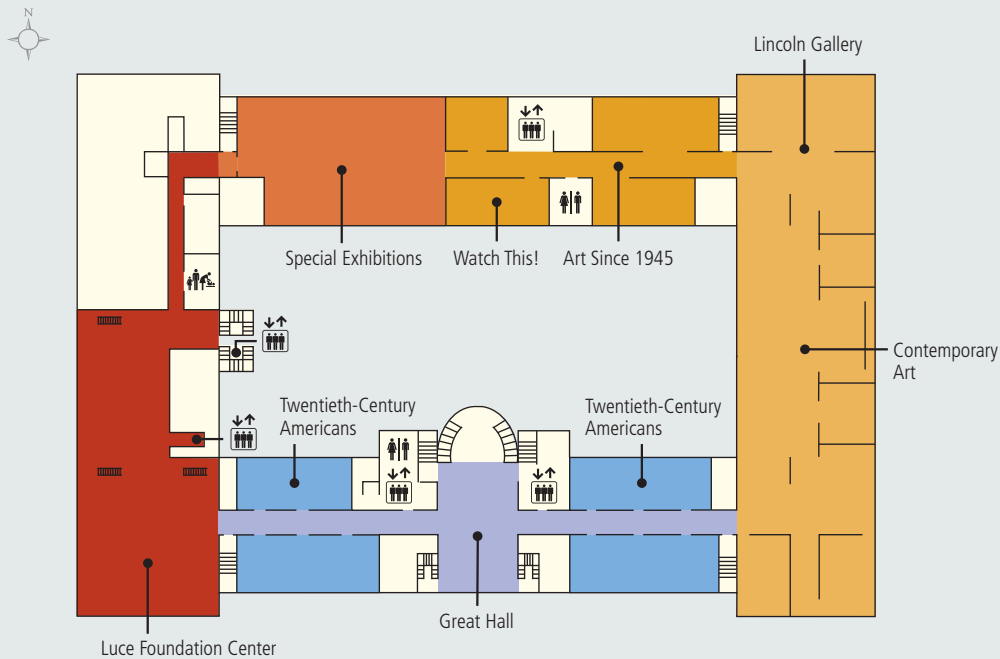

■ Art Since 1945



■ Contemporary Art



■ Twentieth-Century Americans



■ Twentieth-Century Americans

## Third-Floor Mezzanines

### National Portrait Gallery

- BRAVO!
- Champions\*

\* Entrance only from the Great Hall

### Smithsonian American Art Museum

- Luce Foundation Center (Public Study/Art Storage Center)

### Smithsonian American Art Museum and National Portrait Gallery

- Lunder Conservation Center

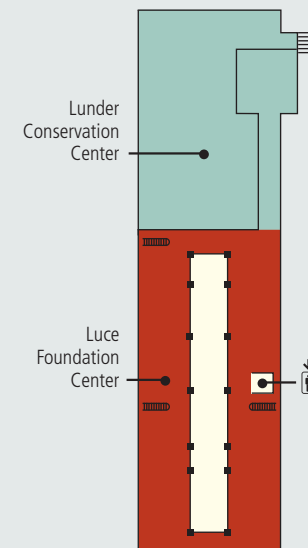
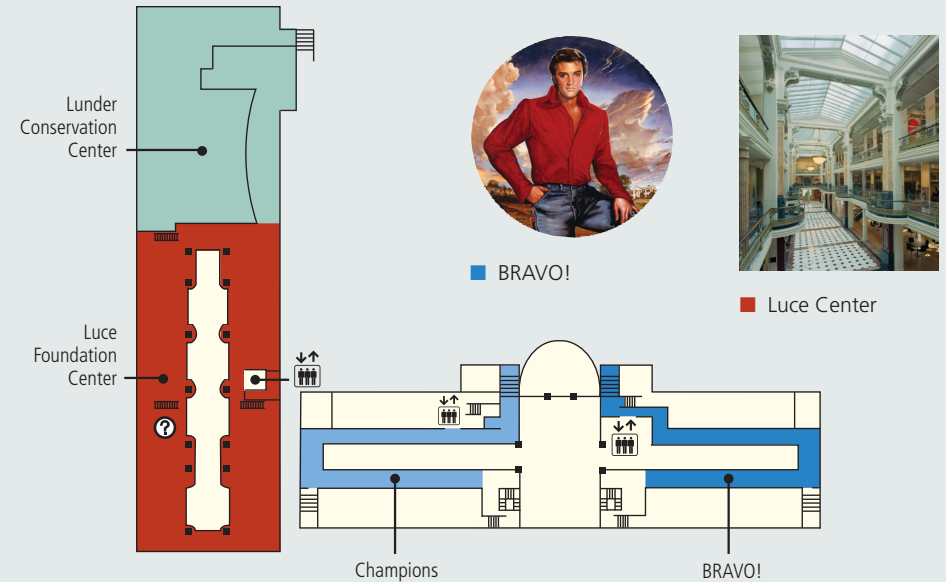

## Fourth Floor

### Smithsonian American Art Museum

- Luce Foundation Center (Public Study/Art Storage Center)

### Smithsonian American Art Museum and National Portrait Gallery

- Lunder Conservation Center